

Met 0 8b 10-YEAR SUMMARY SHEETS

Governed by Public Records Acts

I M P O R T A N T

1. These sheets are a VITAL part of the permanent data archives of the Office, and are stored in Met08 for all decades for practical and historical reasons, including ready access, rather than be stored in Technical Archives.
2. For many old stations these sheets are the ONLY record of available data.

ENTRIES

3. All entries must invariably be made in permanent ink (nowadays normally in black waterproof ink), be perfectly legible and comments sufficiently intelligible to those reading them decades after the event.
4. Every attempt should be made to ensure that any follow-up action is adequately cross-referenced to a previous entry.
5. Retrospectively effective comments MUST be entered on the station's 10-year sheets for all relevant previous decades, not just on the latest decade's sheet.

BORROWING OF 10-YEAR SHEETS PROHIBITED

6. On no account whatsoever are the original sheets to be lent to other branches, and care is to be exercised if sheets are wanted by sections other than Met08b within Met08.
7. These sheets may only be extracted from their binders for the very short periods required during any manuscript updating, or whilst actually being photocopied. It is important that temporarily extracted sheets are returned to their correct numerical position by station number; and if more than one decade's sheets for a station are extracted at the same time, very special care needs to be taken to ensure that each decadal sheet is returned to the correct decadal binder.

The discovery of any station's sheet missing from the binder must be reported personally to HSO-in-charge RAINMASTER.

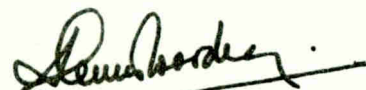

Head of Hydrometeorological
Data Systems

KEEP as top enclosure of each binder

RAINFALL at Glenmoriston, Cluanie Inn.

County of Rose & Cromarty

Observer..... per Captain McLean.

River Basin..... 1 - head - moriston

.....*Rain Gauge, by*.....

[illegible]

Position of Station on reduced Ordnance Survey } No. of Map.....
 Map, 2 miles to 1 inch Series

Reference No.....

[illegible]

RAINFALL at Monar

County of Koss

Observer J. Stirling, Esq.

River Basin Beaulf - 2

Snawdon Rain Gauge, by

Diameter										5	
Height										0 9	
Altitude										700	
Year	1920	1921	1922	1923	1924	1925	1926	1927	1928	1929	1930
January										} 1.75	9.81
February											(1.40)
March										1.87	5.42
April										4.67	4.13
May										3.95	6.74
June										5.33	4.74
July										1.42	2.57
August										8.12	11.15
September										7.02	7.56
October										13.98	14.92
November										9.18	10.83
December										15.76	8.69
TOTALS										72.05	(87.96)

1929. Trees 45 ft. high, 25 yds. N.E.
1930. Feb adjusted with concurrence of observer for loss of snow.

Position of Station on reduced Ordnance Survey Map, 2 miles to 1 inch Series				No. of Map		Reference No.		
Date.	Lat. N.	Long.	Railway Station.	Distance from gauge	Direction from gauge	Parish Church.	Distance from gauge	Direction from gauge
1929			Beaulf	24 m.	E.	Erchless	14 m.	E.

RAINFALL at Fortrose, ~~Hallgill~~

County of ROSS Observer A. Thom Esq

River Basin Monay Firth Coast-Streams 3.

L.C. Rain Gauge, by _____

Diameter ...	5"			5"								
Height	1 0			1 0								
Altitude ...	69	70		70							69'	
Year	1920	1921	1922	1923	1924	1925	1926	1927	1928	1929	1930. MEANS.	SUMS
January ...	2.35	2.09	2.70	2.39	1.28	1.95	1.02	2.24	4.00	1.64	2.19	22.85
February ...	3.11	.83	1.41	1.35	1.65	2.41	1.09	0.82	2.67	.27	.64	16.25
March	2.17	1.22	1.36	.38	.96	1.58	3.06	1.17	1.37	1.43	.91	14.61
April	1.78	.65	1.39	1.86	.58	1.19	2.03	1.67	.94	1.16	1.07	14.32
May	1.48	2.34	2.18	2.38	2.27	2.07	1.71	1.86	1.73	1.76	1.41	21.19
June36	.75	.64	.70	2.18	.33	.85	2.56	2.61	1.52	1.39	13.89
July	2.89	2.37	1.55	1.95	3.92	1.38	1.11	2.26	1.45	1.96	2.44	23.28
August	2.08	2.14	1.91	4.42	3.06	.78	1.80	2.78	3.42	3.36	4.57	30.32
September...	2.03	.67	1.42	1.74	2.33	2.87	2.24	5.34	2.06	1.76	2.27	24.73
October72	1.49	1.51	2.63	3.16	1.11	3.17	3.91	2.46	3.09	3.61	26.86
November...	.83	.76	1.19	2.19	.89	.48	2.37	2.36	2.70	1.62	4.76	20.15
December...	.85	4.03	1.38	2.17	2.47	1.89	1.76	0.86	1.80	2.11	1.47	20.79
TOTALS...	(20.65) D	19.34 D	18.64 D	24.16 D	24.75 D	18.04 D	22.21 D	27.83 D	27.21 D	19.68 D	26.73 D	249.24

1920. Gauge moved 10.2.20. 300ft E of old site
House 20ft high 48ft W.

Position of Station on reduced Ordnance Survey Map, 2 miles to 1 inch Series				No. of Map		Reference No.	
Date.	Lat. N.	Long. W.	Railway Station.	Distance from gauge	Direction	Parish Church.	Distance from gauge
1920	57°35'	4°8'	Fortrose H.R.	1/4 mi	N	Rosemarkie	1 1/2 mi E

RAINFALL at Fearn, ^{Gleanies}~~Blanes~~

County of Ross & Cromarty Observer J. M. Murray, Esq.

River Basin Moray Firth Coast Streams, - 3 (1926) A. Munro Esq. (gale).

Snowdon Rain Gauge, by (125)

Diameter ...					5				5			
Height					11		1.0		11"			
Altitude ...					200				200			
Year	1920	1921	1922	1923	1924	1925	1926	1927	1928	1929	1930. MEANS.	
January ..	(1253)	(209)	(210)	(188)	1.34	1.96	1.63	2.25	2.96	.44	1.14	2032
February ...	(119)	(142)	(142)	(143)	.86	2.62	1.92	1.42	1.72	.43	.60	1403
March	(185)	(135)	(140)	(132)	1.15	1.17	1.91	1.06	1.92	.31	.63	1307
April	(163)	(137)	(169)	(251)	.70	1.22	2.06	1.73	.59	1.16	1.26	1492
May	(268)	(294)	(261)	(229)	3.16	2.52	2.18	1.77	1.79	2.08	1.92	2594
June	(62)	(96)	(90)	(90)	1.78	.83	1.60	2.57	2.12	2.34	1.88	1650
July	(1.63)	(1.73)	(1.45)	(1.81)	2.86	1.98	1.14	1.19	1.75	1.24	1.67	1845
August	(1.10)	(2.46)	1.78	(4.71)	3.95	1.16	1.75	1.33	2.62	3.76	4.46	2908
September...	(1.57)	(1.11)	(204)	(2.55)	3.71	3.00	2.10	4.28	2.10	2.02	2.61	2703
October	(1.32)	(2.00)	(114)	(4.24)	3.46	1.86	3.08	3.96	2.38	3.75	3.71	3090
November...	(1.60)	(.94)	(183)	(1.57)	1.18	.76	2.58	1.88	3.44	1.86	2.99	2063
December...	(1.84)	(3.13)	(.94)	(2.39)	2.44	1.85	1.73	1.22	1.98	1.80	2.07	2142
TOTALS...	(1950)	19.50	(19.30)	26.66	26.62	20.93	23.68	24.66	25.37	21.19	24.94	25229
					2	2	2	2	2	2	2	5

1926. Garden Wall 10 ft. high 24 ft. away

101.99 of Parkburn

Cpt. W. 1916 - 50 amp h

16739

Position of Station on reduced Ordnance Survey } No. of Map _____ Reference No. _____
Map, 2 miles to 1 inch Series

Date.	Lat. N.	Long.	Railway Station.	Distance from gauge	Direction from gauge	Parish Church.	Distance from gauge	Direction from gauge
1924.			Fearn	5 1/2 mi	W.	Parbat	3 1/2 mi	E.

Observer W. M. Christy Esq D. D. Munro.

Rain Gauge, by

*Position of Station on reduced Ordnance Survey
Map, 2 miles to 1 inch Series*

No. of Map.

Reference No.....

[illegible]

RAINFALL at Achnasheen, Ledgovan

County of ROSS Observer Mr J. J. Macrae

River Basin Gromarty Firth - H. D. D. Macrae Esq (1927)

Glaisher Rain Gauge, by (125)

Diameter ...	5			5							
Height	1 0			1 0							
Altitude ...	500			500							
Year	1920	1921	1922	1923	1924	1925	1926	1927	1928	1929	MEANS.
January ...	13.42	14.97	5.56	15.04	6.57	9.16	7.59	11.30			
February ...	14.96	4.23	6.21	4.08	5.72	7.52	4.49	2.80			
March	10.58	12.41	5.13	1.27	1.84	8.46	11.30	4.51			
April	4.80	3.29	4.84	4.09	4.27	6.77	3.37	11.47			
May	5.86	5.31	9.26	7.36	2.93	4.56	2.99	3.08			
June	2.68	2.12	4.40	6.69	3.31	2.21	3.71	6.81			
July	4.57	4.75	3.26	5.48	4.44	3.34	3.18	3.68			
August	3.21	4.32	4.49	6.98	6.92	2.73	4.71	5.67			
September...	5.05	4.93	3.26	6.22	6.70	5.68	6.70	6.85			
October	1.45	9.87	3.31	10.39	5.18	5.60	7.03	9.13			
November...	9.05	2.71	7.63	7.47	3.91	2.43	6.25	6.17			
December...	6.31	14.70	9.41	8.13	11.76	9.90	10.11	.90			
TOTALS...	81.94	83.61	66.76	83.20	63.55	68.36	71.43	72.37	N.R.	N.R.	N.R.

1926. Gauge moved 1¹/₂ in. 15 yds. S.E.
Trees 12 ft. high 10 yds. surrounding gauge.

Position of Station on reduced Ordnance Survey Map, 2 miles to 1 inch Series				No. of Map		Reference No.	
Date.	Lat. N.	Long. W.	Railway Station.	Distance from gauge	Direction	Parish Church.	Distance from gauge
1920	57 ¹ / ₂	5°	Achnasheen	1/4 mi	E	Lochluchart	11 mi N.E.

RAINFALL at Muir of Ord, Fairburn

County of Koss Observer Major J. S. Stirling
River Basin Cromarty Firth &
Snawdon Rain Gauge, by

Diameter										5	
Height										10	
Altitude										500	
Year	1920	1921	1922	1923	1924	1925	1926	1927	1928	1929	1930
January		42.53			(4900)					.72	4.87
February		25.48			(2960)					.31	.70
March		20.78			(2400)					.53	1.91
April		17.56			(2050)					1.71	1.09
May		22.89			(2650)					2.38	2.06
June		14.92			(1750)					2.26	2.15
July		24.22			(2800)					2.22	2.80
August		24.64			(2850)					3.85	6.80
September		23.68			(2750)					1.95	3.04
October		27.66			(3200)					3.97	6.15
November		23.62			(2700)					4.52	4.91
December		32.13			(3700)					6.25	3.34
TOTALS		300.11			(3470)					30.67	39.82

1929. Tree 45' high, 55' N.E.
" 65' " 73' N.E.
" 35' " 50' S.

Puhir 1424 to 1433
Fairburn 115.355/0 d Shillpeth

Position of Station on reduced Ordnance Survey Map, 2 miles to 1 inch Series				No. of Map		Reference No.	
Date.	Lat. N.	Long.	Railway Station.	Distance from gauge	Direction	Parish Church.	Distance from gauge
1929			Muir of ord	4½ m.	E. S. E.	Urray	3½ m. E.

Rain Gauge, by

30011

(*1383) Wt. 1671—6044. 10,000. 4/21. J. T. & S., Ltd. 160.

RAINFALL at Dingwall (The Academy)

County of Ross Cromarty Observer G. L. Turnbull Esq.

River Basin Cromarty Firth H James Clark Esq (1929)

MO. Rain Gauge, by _____

Diameter ...								5	5"		
Height								1.0	1		
Altitude ...								18	18'		
Year	1920	1921	1922	1923	1924	1925	1926	1927	1928	1929	1930. MEANS.
January ...								4.65	5.92	.57	3.99
February ...								1.03	3.87	.42	.55
March								1.54	2.47	.69	1.24
April								2.71	0.86	1.27	.84
May								1.66	1.75	1.75	1.54
June								2.68	2.54	1.82	2.03
July								2.18	1.78	1.57	2.26
August								2.81	4.73	3.39	5.08
September...								3.86	2.20	2.07	2.12
October								4.99	3.58	3.63	4.66
November...								2.59	4.06	3.32	4.36
December...								1.01	3.00	3.92	2.46
TOTALS...								31.71	36.76	24.42	31.13

1928 Wall 5' high 50 S & E
monument 33' .. 35' NW

Position of Station on reduced Ordnance Survey } No. of Map _____ Reference No. _____
Map, 2 miles to 1 inch Series

Date.	Lat. N.	Long.	Railway Station.	Distance from gauge	Direction	Parish Church.	Distance from gauge	Direction
			Dingwall	1/4m	SE	Dingwall	50 yds	NW.

RAINFALL at Cromarty House

County of Ross Observer Brig-Gen W. G. Ross C.B. d. 11/22.
River Basin Cromarty Firth & per B. Ross (gdr.)
Howard Rain Gauge, by A. N. Stones (1929) & a. Ross (..)

Diameter ...	5"			5"		5"			5"		
Height	1 0			1 0		1' 0"			1		
Altitude ...	60			60		85'			80		
Year	1920	1921	1922	1923	1924	1925	1926	1927	1928	1929	1930. MEANS.
January ...	3.16	2.82	2.02	2.48	1.69	2.30	1.82	2.72	3.43	.54	1.48
February ...	2.77	.51	2.13	1.88	.62	3.15	1.83	.90	2.00	.45	.50
March	1.68	2.01	1.73	.56	1.36	1.41	2.72	1.51	1.67	.27	.76
April	1.56	.39	2.33	2.89	.56	1.27	1.84	1.64	.91	.95	.99
May	1.76	3.78	2.44	2.93	3.66	2.25	2.05	1.66	2.22	2.32	1.61
June65	.81	1.05	.75	1.80	.88	2.30	2.44	2.75	2.17	1.61
July	2.48	2.57	3.04	1.96	3.32	2.64	1.31	2.11	1.67	1.55	1.57
August	2.41	2.14	2.06	5.15	4.16	1.07	1.77	1.86	2.74	3.42	4.41
September...	2.50	1.25	1.96	1.75	4.84	2.87	2.03	5.02	2.35	1.90	2.11
October98	1.66	1.59	3.14	2.79	1.77	3.80	4.40	2.20	3.87	2.50
November...	2.32	.96	1.06	1.95	1.15	.69	2.53	2.28	3.15	1.97	3.80
December...	1.63	2.62	1.60	1.90	3.09	2.60	1.41	1.35	2.20	1.88	1.98
TOTALS...	23.90	21.52	23.01	27.34	29.04	22.90	25.41	27.89	27.29	21.29	23.32

Position of Station on reduced Ordnance Survey Map, 2 miles to 1 inch Series				No. of Map		Reference No.	
Date.	Lat. N.	Long.	Railway Station.	Distance from gauge	Direction	Parish Church.	Distance from gauge
1911			Invergordon	6 mi	W	Cromarty	1/2 mi NW.

RAINFALL at Cromarty

County of ROSS Observer Board of Northern Lights

River Basin Cromarty Firth &

Rain Gauge, by _____

Diameter ...	3										
Height	1 0										
Altitude ...	28								21'		
Year	1920	1921	1922	1923	1924	1925	1926	1927	1928	1929	1930 MEANS.
January ...	2.62	1.99	1.96	2.24	.89	.96	1.20	1.53	2.37	.46	2.26
February ...	2.59	.54	1.70	1.33	.36	2.58	1.53	.66	.94	.29	.54
March	1.36	1.82	1.56	.41	1.25	1.10	1.95	.94	1.69	.16	.83
April	1.12	.41	1.68	2.16	.40	1.22	1.48	1.39	.90	1.06	.96
May	1.48	2.69	2.10	2.68	2.58	1.88	1.66	1.31	2.45	2.45	1.71
June58	.57	.67	.49	1.47	.71	1.76	1.61	2.89	1.21?	1.72
July	2.08	2.35	2.09	1.83	2.42	2.08	.82	2.05	1.23	1.58	1.50
August	1.44	1.43	2.52	3.04	2.76	.62	1.64	1.30	2.73	3.28	5.10
September...	1.81	1.17	1.23	1.66	3.20	1.77	1.99	2.69	2.05	1.09?	2.10
October90	1.55	.93	2.31	2.23	1.33	3.39	2.24	1.89	4.00	3.28
November...	2.25	1.09	1.18	1.33	1.17	.61	1.63	1.68	3.57	1.84	4.30
December...	1.13	2.38	1.40	1.41	2.06	1.85	.96	1.19	1.28	1.83	1.86
TOTALS...	19.36	17.99	19.02	20.89	20.79?	16.71?	20.01?	18.59?	23.99?	19.25?	26.16

1923. ? low. Catechism in 1926. 6. in garden. Sundial 4ft. high 9ft. GSE
gooseberry bushes to S 3-4 ft. high 10-15ft. away to S & SE; well
5ft. high 17 yds W + 10 yds S. Buildings 17 yds N;
Standard gauge on 1 ft. above ground.

1929. June & Sept. low.

Position of Station on reduced Ordnance Survey Map, 2 miles to 1 inch Series				No. of Map _____		Reference No. _____	
Date.	Lat. N.	Long.	Railway Station.	Distance from gauge	Direction	Parish Church.	Distance from gauge

RAINFALL at Invergordon The Grd

County of Inverness^{Ross} Observer W. G. Paterson Esq

River Basin Cromarty Firth 4.

* Rain Gauge, by _____

Diameter ...	5										
Height	1 1		14 0								
Altitude ...	50										
Year	1920	1921	1922	1923	1924	1925	1926	1927	1928	1929	MEANS.
January ...	2.81	3.21	1.63								
February ...	2.28	.49	1.72								
March	1.65	1.55	1.14								
April	1.50	.47	2.55								
May	1.52	2.75	2.54								
June35	.70	.74								
July	2.14	2.59	3.19								
August	2.21	1.61	1.91								
September...	2.17	.82	1.56								
October	1.22	1.65	1.59								
November...	2.00	.78	1.07								
December...	1.82	3.03	1.44								
TOTALS...	21.67	19.65	21.08								
	D		D								

* 1921. Obs. sap gauge of modern pattern.
None to N, sometimes to E, garden to W (open to S.) about 14 1/2 for gauge.

Position of Station on reduced Ordnance Survey Map, 2 miles to 1 inch Series				No. of Map		Reference No.	
Date.	Lat. N.	Long.	Railway Station.	Distance from gauge	Direction	Parish Church.	Distance from gauge
1911	57° 42'	4° 9'	Invergordon	1 1/2 mi	W	Rosskeen	3 1/2 mi W.

RAINFALL at Alness, Andross Castle

County of Ross Observer Mr W. L. Minty

River Basin Gromarty Firth & John McElross
Mr J. McElross

Rain Gauge, by Stevenson (Edin.)

Diameter ...	5			5							
Height	1 0			1.0							
Altitude ...	450			450							
Year	1920	1921	1922	1923	1924	1925	1926	1927	1928	1929	1930. MEANS.
January ...	5.81	6.13	4.16	5.92	2.03	4.65	3.18	5.47	6.71	.99	4.01
February ...	4.91	.88	4.00	3.95	2.63	6.92	3.19	1.15	4.53	.65	1.21
March	2.80	3.79	2.89	1.08	1.86	3.30	4.38	1.88	3.89	.61	1.95
April	2.80	1.53	4.01	3.99	1.47	3.15	3.27	3.27	1.64	1.89	1.81
May	2.92	3.26	3.30	4.46	5.77	3.80	2.96	2.37	3.17	2.08	2.56
June54	.84	1.04	.96	2.16	.63	3.16	3.44	3.29	1.68	1.93
July	2.29	2.95	3.30	3.50	4.32	2.90	1.92	3.56	1.93	2.39	2.59
August	2.36	2.21	2.16	6.12	4.59	1.51	2.01	3.76	5.26	5.13	7.05
September...	2.68	1.55	1.98	2.83	6.20	2.62	2.60	6.43	2.71	2.39	3.33
October	1.86	2.90	2.72	5.15	2.28	2.34	6.76	6.70	4.39	4.87	6.12
November...	4.56	1.63	2.38	3.74	2.03	1.77	5.33	3.25	5.35	3.38	7.20
December...	3.31	6.00	3.75	3.54	4.45	4.74	2.78	1.71	4.28	4.05	3.27
TOTALS...	36.84	33.67	35.69	45.24	39.79	38.33	41.54	42.99	47.15	30.11	43.03
	D	D	D	D	D	d	D		D	D	D

Situation open.

Position of Station on reduced Ordnance Survey Map, 2 miles to 1 inch Series				No. of Map		Reference No.	
Date.	Lat. N.	Long. W.	Railway Station.	Distance from gauge	Direction	Parish Church.	Distance from gauge
1920	57° 45'	4° 21'	Alness	5 mi	SE	Rosskeen	7 mi
							SE

RAINFALL at Tain, Castle Brae House

County of Ross Observer G. D. Schofield

River Basin Dornoch Firth 5-

Rain Gauge, by

Diameter ...	5-										
Height	1 0										
Altitude ...											
Year	1920	1921	1922	1923	1924	1925	1926	1927	1928	1929	MEANS.
January ...	3.63										
February ...	3.01										
March	1.64										
April	1.71										
May	2.28										
June69										
July	1.90										
August	2.24										
September...	1.99										
October	1.62										
November...	2.67										
December...	2.22										
TOTALS...	25.60										

Position of Station on reduced Ordnance Survey
Map, 2 miles to 1 inch Series

No. of Map

Reference No.

Date.	Lat. N.	Long.	Railway Station.	Distance from gauge	Direction	Parish Church.	Distance from gauge	Direction
1920			Tain	300 yds	N E	Established	1/2 mi	S. E.

RAINFALL at Tain, Ardlaraich

County of Perth

Observer Lt. Col. G. MacIver Ritchie

River Basin Dornoch Firth 5-

Howard Rain Gauge, by
(1929)

Diameter ...							5				
Height							0.6		1	1.0	
Altitude ...							400		400		
Year	1920	1921	1922	1923	1924	1925	1926	1927	1928	1929	1930 MEANS.
January ...							2.30	3.79	4.71	.62	2.57
February ...							2.44	1.33	2.60	.54	.78
March							2.62	1.78	2.50	.61	1.26
April							2.31	2.78	1.08	1.69	1.36
May							3.46	2.29	2.10	2.60	2.42
June							2.08	2.65	3.25	2.79	1.81
July							1.46	2.53	2.02	1.66	2.24
August							2.63	2.19	2.81	4.78	6.32
September...							2.58	4.76	2.68	2.72	2.29
October							4.01	5.46	3.40	4.76	5.03
November...							3.97	2.59	4.43	2.79	3.91
December...							2.44	0.80	3.54	3.10	2.20
TOTALS...							32.30	32.95	35.12	28.66	32.19
							D	D	D	D	D

16122

1929. No objects near g. Perfectly clear open lawn.

Position of Station on reduced Ordnance Survey Map, 2 miles to 1 inch Series				No. of Map		Reference No.	
Date.	Lat. N.	Long.	Railway Station.	Distance from gauge	Direction	Parish Church.	Distance from gauge
1929.			Tain	1½ m.	E.S.E.	Tain	1¼ m. E.S.E.

RAINFALL at Tarbatness

County of ROSS

Observer Board of Northern Lights

River Basin Dornoch Firth 5-

Rain Gauge, by

Diameter ...	8										
Height	4 0										
Altitude ...	175										
Year	1920	1921	1922	1923	1924	1925	1926	1927	1928	1929	1930 MEANS.
January ...	2.48	2.05	2.06	1.85	1.48	1.30	1.83	2.16	3.64	.78	1.18
February ...	1.17	.41	1.39	1.40	.95	2.46	1.80	1.41	1.29	.45	.58
March	1.81	1.32	1.37	.32	1.51	1.20	1.87	.96	1.71	.45	.58
April	1.60	.36	1.66	2.47	.66	1.42	1.97	1.56	.43	1.69	.87
May	2.63	2.88	2.56	2.25	2.88	2.39	1.03	1.70	1.60	2.34	1.58
June61	.94	.88	.88	1.57	.71	1.20	2.75	2.07	1.69	1.37
July	1.60	1.69	1.42	1.78	3.20	2.12	1.00	.37	1.82	.91	1.74
August	1.08	2.41	1.75	4.62	4.02	1.32	1.40	1.89	1.69	3.55	4.83
September...	1.48	1.09	2.00	2.50	3.85	2.06	2.35	5.02	2.10	2.42	2.09
October	1.29	1.96	1.12	4.16	2.69	2.14	3.20	4.20	2.31	2.95	3.48
November...	1.57	.92	1.79	1.54	1.92	.86	2.73	1.88	3.83	1.60	3.45
December...	1.80	3.07	.92	2.35	2.63	1.51	2.41	1.44	2.55	1.82	1.89
TOTALS...	19.12	19.10	18.92	26.12	27.36	19.49	22.79	25.34	25.04	20.65	23.64

Catchment 1926 is on level grass land. Stonewall 6ft. high
45 yds on N + 62 yds on E ; to S ground slopes down to cliffs.
Standard g. 1 in 22" above ground.

16 4 31
3 3 4

101.9

Position of Station on reduced Ordnance Survey
Map, 2 miles to 1 inch Series

No. of Map

Reference No.

Date.	Lat. N.	Long.	Railway Station.	Distance from gauge	Direction	Parish Church.	Distance from gauge	Direction

County of R & G. Observer W. Macpherson Station master

River Basin some 7 m — 5

Rain Gauge, by

Diameter ...											
Height											
Altitude ...											
Year	1920	1921	1922	1923	1924	1925	1926	1927	1928	1929	MEANS.
January ...				4.85	2.10	4.21			2.00		
February ...				2.50	2.48	4.33			1.00		
March67	2.13	3.22			2.00		
April				3.06	1.56	2.59					
May				3.02	1.95	2.73					
June90	1.71	.46			3.00		
July				3.52	3.64	3.21					
August				4.33	4.42	.68					
September...			# 1.52	2.46	3.48	2.32					
October			1.31	3.64	2.58	4.25					
November...			2.25	3.00	1.69	(1.72)					
December...			2.56	3.29	4.25	(3.95)					
TOTALS...				35.54	31.99	33.67	NO	NO	N.O.	NO	N.R.

1922. G. issued on loan 8/22.
1925. Nov. & Dec. corrected for snow.

Position of Station on reduced Ordnance Survey Map, 2 miles to 1 inch Series

No. of Map

Reference No.

Date.	Lat. N.	Long.	Railway Station.	Distance from gauge	Direction	Parish Church.	Distance from gauge	Direction

RAINFALL at Bonar Bridge School

County of Ross & Cromarty Observer D. K. Macrae

River Basin Gornoch Firth - 5.

Rain Gauge, by _____

Diameter ...									5		
Height											
Altitude ...									190		
Year	1920	1921	1922	1923	1924	1925	1926	1927	1928	1929	MEANS.
January ...											
February ...											
March											
April											
May											
June											
July									1.70		
August									2.37		
September...									1.65		
October									2.75		
November...									3.10		
December...									2.53		
TOTALS...									✓	NO	NR.

Position of Station on reduced Ordnance Survey } Map, 2 miles to 1 inch Series				No. of Map		Reference No.	
Date.	Lat. N.	Long.	Railway Station.	Distance from gauge	Direction	Parish Church.	Distance from gauge
			Bonar Bridge	1 1/2 M	W	Breich	1/2 M

RAINFALL at Glen Oykehl, Lumberay Lodge,
County of Koss & Co. Observer Sir George H. Kendrick.
River Basin Dornoch Firth - 5.

Rain Gauge, by _____

Diameter ...											
Height											
Altitude ...											
Year	1920	1921	1922	1923	1924	1925	1926	1927	1928	1929	MEANS.
January ...						8.25					
February ...						7.00					
March						4.75					
April						4.50					
May						4.75					
June						2.00					
July						(3.75)					
August						3.50					
September...						4.50					
October						5.00					
November...						2.00					
December...						4.75					
TOTALS...						(54.75)					

1925. July corrected by map.

Position of Station on reduced Ordnance Survey
Map, 2 miles to 1 inch Series

No. of Map

Reference No.

Date.	Lat. N.	Long.	Railway Station.	Distance from gauge	Direction from gauge	Parish Church.	Distance from gauge	Direction from gauge

RAINFALL at Ardgay, Gledfield

County of ROSS & Cromarty Observer James G. Ross Esq

River Basin Donoch Firth 5

Rain Gauge, by

Diameter ...											
Height											
Altitude ...											
Year	1920	1921	1922	1923	1924	1925	1926	1927	1928	1929	MEANS.
January ...							2.84	4.98			
February ...							2.65	1.57			
March							4.21	2.64			
April							2.28	4.60			
May							3.22	2.70			
June							5.27	5.13			
July							2.00	3.16			
August							2.56	3.75			
September...							3.47	6.69			
October							5.51	5.97			
November...							5.48	3.85			
December...							4.61	1.56			
TOTALS...							44.10	46.60	N.R.	N.R.	N.R.

Position of Station on reduced Ordnance Survey
Map, 2 miles to 1 inch Series

No. of Map

Reference No.

Date.	Lat. N.	Long.	Railway Station.	Distance from gauge	Direction from gauge	Parish Church.	Distance from gauge	Direction from gauge

RAINFALL at Ullapool, Inverpolly Lodge

County of ROSS

Observer A. Taylor Esq W. J. Milne Esq. 1922

River Basin Enard Bay 6.

Rain Gauge, by _____

Diameter ...	5										
Height	4 0										
Altitude ...	25										
Year	1920	1921	1922	1923	1924	1925	1926	1927	1928	1929	MEANS.
January ...	5.00		4.13								
February ...	6.68		3.66								
March	4.30		2.89								
April	1.57		2.38								
May	3.25		5.51								
June	1.11		2.69								
July99		1.90								
August	2.03		3.40								
September...	3.97		1.76								
October56		1.71								
November...	5.57		4.39								
December...	3.95		6.09								
TOTALS...	38.98 2		40.51 2	///							

Position of Station on reduced Ordnance Survey } No. of Map _____
Map, 2 miles to 1 inch Series } Reference No. _____

Date.	Lat. N.	Long. W.	Railway Station.	Distance from gauge	Direction	Parish Church.	Distance from gauge	Direction
1920	58° 4' 20"	5° 15' 30"	Garve H.R.	53 mi	S E	Lochbroon		

RAINFALL at Braemore, Loch a Phraoin

County of ROSS & Cromarty Observer P. Matheson Esq.

River Basin Loch Broom & C. Rev Sir Montague Fowler Bt.

Glaisher Rain Gauge, by Nag.
(125)

Diameter ...			8	8		8"			8		
Height			0.9	0.9		8"			9		
Altitude ...	810		822	822		830'			822		
Year	1920	1921	1922	1923	1924	1925	1926	1927	1928	1929	1930 MEANS.
January ...	14.15	17.90	8.59	18.62	5.02	9.27	7.50	11.26	11.43	1.37	8.52
February ...	14.35	6.82	7.71	5.46	6.42	6.22	3.39	1.03	8.39	.41	(1.20)
March	9.69	15.42	3.71	1.52	1.39	7.63	7.04	4.62	2.72	1.67	2.46
April	5.61	3.83	4.91	3.51	4.15	5.98	3.75	11.80	2.51	4.46	2.19
May	6.21	4.38	7.59	8.68	2.53	4.66	2.91	2.72	2.96	1.88	5.32
June	1.41	3.47	4.30	5.52	4.40	1.92	2.97	6.97	6.26	4.15	3.15
July	4.79	3.95	3.16	5.56	4.23	3.45	2.85	2.25	5.21	3.35	4.23
August	4.41	3.44	5.34	8.74	8.48	3.18	4.73	4.34	5.51	6.85	8.55
September...	5.73	6.11	3.97	7.27	10.34	8.13	5.73	7.86	4.86	5.03	5.92
October	1.68	8.08	2.71	11.64	5.03	6.10	7.92	7.41	6.94	10.71	11.59
November...	9.25	2.65	8.52	8.94	3.04	2.95	7.66	7.50	12.46	6.87	9.71
December...	7.05	14.75	8.87	9.51	10.74	8.12	10.48	0.78	8.40	11.12	7.06.
TOTALS...	84.28	90.80	69.38	94.97	65.77	67.61	66.93	68.54	77.65	57.87	(69.90)

1922. Loch 30 ft W
Hills 2000-3500 ft S & N

1920/21/26. Values supplied by Rev. Sir Montague Fowler.
— See letter dated 7.7.27.

1930 Feb. amended for loss of snow.

Position of Station on reduced Ordnance Survey Map, 2 miles to 1 inch Series					No. of Map		Reference No.	
Date.	Lat. N.	Long.	Railway Station.	Distance from gauge	Direction	Parish Church.	Distance from gauge	Direction
1922			Garve	24½ mi	S.E.	Lochbroom	8 mi	N

County of Ross & Cromarty Observer Rev Sir Montague Zoller Br
River Basin Loch Broom & C. 7.

Rain Gauge, by

1920-26. Values supplied by Rev. Sir Montague Fowler.
- See letter dated 7.7.27.

No. of Map

Reference No.

[illegible]

RAINFALL at Braemore House

County of Ross & Cromarty Observer Sir Montague Fowler Bt

River Basin Loch Braemore &c.

Rain Gauge, by _____

Diameter ...							8				
Height							0.7				
Altitude ...	800								800		
Year	1920	1921	1922	1923	1924	1925	1926	1927	1928	1929	1930 MEANS.
January ...			7.60	10.31	6.20	8.90	6.95	11.64	12.35	2.40	10.32
February ...			8.15	4.35	6.80	5.50	4.20	2.46	8.62	1.40	1.95
March			4.25	1.80	4.45	5.53	8.31	2.80	3.60	1.56	3.75
April			6.10	3.16	3.70	4.90	3.71	9.15	2.50	3.50	3.90
May			4.42	6.20	2.80	4.66	4.40	4.90	3.41	2.55	5.00
June			3.30	3.86	3.22	1.63	3.25	7.10	6.32	4.40	3.12
July			4.22	4.78	3.90	4.40	2.34	2.73	7.20	3.60	3.75
August			3.61	7.80	7.80	2.15	4.93	4.22	6.26	6.76	7.50
September...			3.50	6.18	8.90	7.27	4.64	10.18	5.35	6.90	4.55
October			2.12	10.40	4.50	5.20	9.45	8.90	7.54	9.35	10.90
November...			5.70	5.83	2.50	2.49	7.50	7.10	11.35	5.75	10.26
December...			7.50	7.32	8.50	7.65	9.54	.77	9.25	9.30	6.67
TOTALS...	80.77	62.87	60.47	71.99	63.27	60.28	69.22	71.95	83.75	55.47	71.67

1920-26. Values supplied by Rev. Sir Montague Fowler.
- See letter dated 7.7.27.

Position of Station on reduced Ordnance Survey Map, 2 miles to 1 inch Series				No. of Map		Reference No.	
Date.	Lat. N.	Long.	Railway Station.	Distance from gauge	Direction	Parish Church.	Distance from gauge

Rain Gauge, by

* See letter dated 7.7.27.

Reference No.

(^c1383) Wt. 1671-6044. 10,000. 4/21. J. T. & S., Ltd. **160.**

RAINFALL at Ullapool

County of Ross & Cromarty Observer Dr. D. Wallace, Esq.

River Basin L. Broom - 7.

M 645 Rain Gauge, by R. A. F.

Diameter ...			5	5							
Height			1.6	1.6							
Altitude ...			75	75							
Year	1920	1921	1922	1923	1924	1925	1926	1927	1928	1929	1930. MEANS.
January ...				8.46	3.76	6.00	4.26	7.92	8.81	1.37	6.11
February ...				3.22	4.00	5.07	3.01	1.53	6.20	.88	.87
March81	2.97	5.44	7.44	3.65	2.80	1.96	2.70
April				2.66	2.59	4.30	2.35	8.02	2.12	3.31	1.65
May				5.15	2.43	2.68	1.89	2.00	1.37	1.59	2.40
June				3.47	2.72	1.77	2.26	4.40	3.45	3.49	3.04
July				4.37	2.93	2.67	2.83	2.82	4.19	2.57	1.89
August				5.60	8.13	2.81	2.93	2.65	3.53	8.32	7.08
September...			#	5.42	5.47	6.84	5.95	7.15	3.07	5.35	3.23
October			4.48	7.55	4.05	4.86	5.55	6.75	3.92	8.18	7.11
November...			4.45	6.30	2.03	2.87	4.40	5.07	6.05	4.39	8.44
December...			4.96	5.96	6.63	6.32	5.26	.07	5.15	5.41	5.48
TOTALS...				58.97	47.71	51.63	48.13	52.06	50.66	46.82	50.00
			D	D	D	D	D	D	D	D	D

1922. Garden Wall 5 ft. high 10 ft. E.
1922. P. issued on loan. 17.22

Position of Station on reduced Ordnance Survey Map, 2 miles to 1 inch Series					No. of Map		Reference No.	
Date.	Lat. N.	Long. W	Railway Station.	Distance from gauge	Direction from gauge	Parish Church.	Distance from gauge	Direction from gauge
1922	57° 53'	5° 10'	Garve	32 mi	S.E.	Ullapool	200 yds	S.E.

RAINFALL at Loch Torridon, Bendsamph

County of ROSS Observed The Earl of Lovelace

River Basin Loch Ewe, Loch Torridon & L. S. M. Mackenzie (1925)

Howard's Snowdon Rain Gauge, by 042077.

Diameter ...	5"			5							
Height	0 5"		1 0	1 0							
Altitude ...	20			20							
Year	1920	1921	1922	1923	1924	1925	1926	1927	1928	1929	1930 MEANS.
January ...	14.81	17.03	7.49	14.16	8.50	10.17	13.39	14.09	17.55	2.16	14.66
February ...	14.07	3.70	11.95	5.17	5.40	9.87	6.28	3.53	9.60	1.54	1.14
March	10.05	16.38	6.54	3.16	1.74	7.66	9.54	6.76	5.73	1.94	6.56
April	3.47	3.92	5.74	3.93	4.45	7.00	4.47	11.43	4.61	3.90	2.55
May	6.38	4.94	10.25	7.80	3.92	6.02	5.04	4.64	2.41	3.60	4.11
June	3.51	3.19	5.55	7.32	6.33	2.60	3.35	6.32	5.58	5.11	4.26
July	5.12	4.92	4.37	6.71	6.42	3.60	5.87	4.23	6.80	5.45	1.95
August	3.76	4.59	4.51	7.61	7.00	4.20	4.94	5.19	4.49	8.00	10.14
September...	6.44	5.38	3.84	8.94	11.35	7.04	7.05	8.36	5.79	8.54	5.37
October	1.72	10.38	3.35	13.13	6.49	6.57	9.58	9.03	9.09	13.86	10.84
November...	11.02	2.79	7.51	9.26	6.42	4.13	8.40	9.55	11.68	9.16	7.89
December...	7.47	15.01	10.74	11.43	18.21	9.47	6.35	5.50	10.49	13.47	7.68
TOTALS...	87.82	92.23	81.84	98.62	86.23	78.33	84.26	83.63	93.82	76.73	77.15
	D	D	D	D	D	D	D	D	D	D	D

1920 Fruit Trees 3 to 10 ft high.

Position of Station on reduced Ordnance Survey } No. of Map _____ Reference No. _____
Map, 2 miles to 1 inch Series

Date.	Lat. N.	Long. W.	Railway Station.	Distance from gauge	Direction	Parish Church.	Distance from gauge	Direction
1920	57° 31' 43"	5° 31' 38"	Achnasheen	22 mi	E N E	Shieldaig	6 mi	W
1922	57° 15' 28"	5° 25' 34"						

RAINFALL at Poolwe, Inverewe Gardens

County of Perth Observer Mr. R. B. Campbell
J. M. Grant (for R. J. Hambury) 1921
River Basin Loch Ewe, Loch Torridon & C. S. Mr. W. Hapburn 1924
Rain Gauge, by _____

Diameter ...	5"			5"							
Height	0 6			0.6							
Altitude ...	20			20							
Year	1920	1921	1922	1923	1924	1925	1926	1927	1928	1929	1930 MEANS.
January ...	10.98		4.44	8.23	3.81	6.03	6.17	9.58	9.34	2.00	7.08
February ...	9.07		4.76	2.68	3.64	4.47	4.28	1.90	5.60	.89	.66
March	6.38		3.11	.97	2.18	3.78	6.44	4.06	3.43	1.71	2.21
April	1.77		3.72	2.96		4.21	2.86	9.32	3.29	2.65	2.40
May	4.35		8.15	4.82		4.21	3.17	2.73	1.46	2.45	2.17
June	1.95		3.95	3.19		2.82	2.51	4.59	3.65	3.67	3.30
July	4.56		3.98	4.63	3.07	2.31	2.44	4.47	6.69	3.07	1.52
August	4.48		2.99	6.02	4.84	3.64	4.66	7.77	2.52	6.48	6.04
September...	5.20		2.71	5.41	6.21	5.19	7.47	9.55	3.03	6.84	2.68
October87		1.93	9.14	3.86	4.48	6.87	7.77	4.62	9.88	8.69
November...	9.49	1.65	4.18	6.83	4.25	2.98	5.26	59.2	6.87	5.84	8.11
December...	5.67	10.22	6.22	5.98	8.20	6.12	8.47	0.36	6.15	8.10	5.24
TOTALS...	64.77	imp	50.14	60.86	imp	50.24	60.60	68.02	56.68	53.58	50.10
	D	D	D	D	D	D	D	D	D	D	D

1924. Mr. Grant left the end of June, & took with him return for April, - June.

Position of Station on reduced Ordnance Survey Map, 2 miles to 1 inch Series				No. of Map		Reference No.	
Date.	Lat. N.	Long. W.	Railway Station.	Distance from gauge	Direction	Parish Church.	Distance from gauge
1920	5° 40' 47"	5° 36'	Achnasheen	36 mi	S.E.		

RAINFALL at *Rudh Rē Lighthouse*

County of *Ross* Observer *Board of Northern Lights*

River Basin *Loch Ewe, Loch Torridon & C. S.*

Rain Gauge, by _____

Diameter ...				5							
Height				6							
Altitude ...				40							
Year	1920	1921	1922	1923	1924	1925	1926	1927	1928	1929	1930. MEANS.
January ...	5.99	6.27	3.82	4.95	3.48	4.50	5.67	5.39	5.32	2.57	3.87
February ...	5.80	1.61	3.07	3.07	1.73	2.94	2.87	1.30	2.36	.71	.79
March	4.43	5.03	2.01	.89	3.22	2.43	2.66	2.70	4.07	.85	1.93
April	2.35	1.88	2.89	2.26	2.36	2.30	2.17	4.52	1.96	1.63	1.66
May	2.90	2.67	5.53	3.01	1.99	2.99	3.32	1.57	.99	1.85	1.25
June	1.52	1.60	2.65	1.91	3.07	1.63	1.29	2.75	2.35	2.86	2.12
July	2.38	2.09	1.85	3.52	2.38	2.18	1.85	3.44	4.02	2.72	1.04
August	2.46	3.86	2.46	2.84	4.12	3.41	3.47	2.59	1.52	4.98	4.47
September...	3.72	3.95	2.31	4.97	3.67	3.43	4.91	4.91	1.96	5.41	2.05
October	1.77	5.11	1.92	7.80	4.81	4.02	7.70	4.50	4.53	4.72	7.12
November...	6.16	1.31	2.53	5.18	3.81	2.97	3.43	3.80	5.01	3.72	6.48
December...	4.05	7.26	5.97	4.35	6.63	4.77	2.69	.27	3.89	5.04	4.29
TOTALS...	43.53	42.64	37.01	44.75	41.27	37.57	42.03	37.74	37.98	37.06	36.07

Catechism 1926" S. in open about 18ft. from corner of mill
round station + 6ft. from edge of rocks on grassy land.
In strong winds rain seems to be carried over gauge, while
some obstruction seems to take place when rain is from N + NE
as lower + houses shelter S.
standard S. rim 6 in above ground.
Oct 1926. S. moved ^{to SE} about 90ft. ~~away~~ clear of station wall.

Position of Station on reduced Ordnance Survey } No. of Map _____ Reference No. _____
Map, 2 miles to 1 inch Series

Date.	Lat. N.	Long.	Railway Station.	Distance from gauge	Direction	Parish Church.	Distance from gauge	Direction

RAINFALL at Glencarron Lodge

County of ROSS Observer Mr. D.D. Munro

River Basin Loch Carron, Loch Alsh & C. g

Rain Gauge, by _____

Diameter ...	5										
Height	1 0										
Altitude ...	504										
Year	1920	1921	1922	1923	1924	1925	1926	1927	1928	1929	MEANS.
January ...	12.27	17.60	6.74								
February ...	15.00	6.82	6.46								
March	10.31	11.92	1.12?								
April	5.16	3.14	4.57								
May	5.72	4.70	12.05								
June	2.34	2.46									
July	6.12	4.47									
August	3.77	4.98									
September...	4.90	6.85									
October	1.32	10.99									
November...	8.41	2.86									
December ...	7.01	18.57									
TOTALS...	82.33	95.36	imp.								
	D	D	D								

1922 : from M.W.R. & later from M.D. Edin. with remark, "merchandise very low - suggest ignore"

Position of Station on reduced Ordnance Survey Map, 2 miles to 1 inch Series				No. of Map		Reference No.	
Date.	Lat. N.	Long.	Railway Station.	Distance	Direction	Parish Church.	Distance
				from gauge			from gauge

RAINFALL at Glen Shield, Shield House

County of Fross Observer Mr. Colin Campbell

River Basin Loch Garrow, Loch Alsh + C. 9

Inverdon Rain Gauge, by Cassella
8268.

Diameter ...	5"			5							
Height	1 6			1 6							
Altitude ...	30			30							
Year	1920	1921	1922	1923	1924	1925	1926	1927	1928	1929	MEANS.
January ...	10.35	10.14	5.62	11.40	8.92	5.50	11.98				20.25 5193
February ...	16.40	5.64	9.65	5.92	3.60	5.50	5.54				4671
March	9.83	10.15	1.55	3.23	1.47	6.42	10.73				3165
April	4.98	3.32	3.38	3.89	5.18	8.15	4.34				2890
May	7.20	6.40	12.38	6.32	3.80	7.25	3.55				4335
June	2.54	2.04	3.88	5.57	8.57	1.82	3.03				2442
July	6.80	4.24	6.45	6.28	7.20	3.70	6.69				3467
August	4.44	5.57	3.54	11.40	5.86	3.90	7.07				3471
September...	5.12	6.65	4.53	11.23	9.72	5.58	6.75				4283
October	2.85	12.86	2.40	9.68	6.32	5.40	9.97				3951
November...	8.64	1.47	7.20	6.56	6.10	1.96	10.33				3193
December...	7.86	15.35	9.15	8.39	9.75	7.45	10.94				5795
TOTALS...	87.01 M	83.83	69.73	89.87	75.49	62.63 M	90.02 NR	NR	NR	NR	46856 # N.R.

1920. Dyke 4 ft high 40 yds N
1927. Probably ?
See sheet for Glen Shield, Ratagan.

Position of Station on reduced Ordnance Survey Map, 2 miles to 1 inch Series				No. of Map		Reference No.	
Date.	Lat. N.	Long.	Railway Station.	Distance from gauge	Direction	Parish Church.	Distance from gauge
			Kyle of Lochalsh	18 mi	N W	Glen Shield	

RAINFALL at Ratagan, Glen Shiel.

County of Ross, Kentucky

Observer Forestry Commission of Scotland

River Basin *Loch baron, Loch Alsh, v. 9.*

MD. Rain Gauge, by

av 80.0

Diameter ...							5					
Height							1.0					
Altitude ...							12					
Year	1920	1921	1922	1923	1924	1925	1926	1927	1928	1929	¹⁹³⁰ MEANS.	
January ...							11.98	16.25	16.97	2.42	15.66	6328
February ...							5.54	3.71	10.99	1.84	1.15	2323
March							10.73	7.40	6.46	2.87	4.88	3184
April							4.34	13.55	4.07	4.29	2.91	2916
May							3.55	3.29	1.26	4.74	5.30	1814
June							3.03	6.10	6.05	5.02	6.52	2572
July							6.69	4.02	12.18	5.23	2.36	3048
August							7.07	6.14	4.42	7.69	10.61	3593
September...							6.75	9.41	7.11	8.14	4.88	3629
October							9.07	10.05	10.90	16.64	12.09	5875
November...							10.33	8.78	11.17	9.50	10.96	5074
December...							10.94	4.49	10.29	14.79	9.65	4616
TOTALS...							90.02	89.19	101.87 D.	82.67 D.	85.97 D.	44972

45372

Position of Station on reduced Ordnance Survey
Map, 2 miles to 1 inch Series

} *No. of Map*.....

Reference No.

[illegible]

RAINFALL at Loch Carron, Plockton

County of Pross Observer Mrs Anstruther Mackay

River Basin Loch Carron, Loch Alsh & C. g

Snowdon Rain Gauge, by Howard Wilson

Diameter ...	5			5							
Height	1 0			1 0							
Altitude ...	4			8							
Year	1920	1921	1922	1923	1924	1925	1926	1927	1928	1929	MEANS.
January ...	7.87	9.40	4.87	9.17	6.60						
February ...	8.05	2.75	8.04	2.60	3.43						
March	6.34	10.15	3.09	1.66	1.76						
April	2.42	2.58	2.66	3.29	3.38						
May	4.46	4.20	6.34	3.55	2.26						
June	2.55	2.00	3.46	4.47	4.53						
July	3.79	3.68	3.62	5.33	4.27						
August	2.54	3.17	2.98	7.97	4.23						
September...	3.44	4.10	2.05	5.40	5.64						
October	1.19	5.80	2.64	9.61							
November...	6.12	1.71	5.45	4.81							
December...	2.26	8.87	6.47	6.82							
TOTALS...	51.03	58.41	51.67	65.68							

1920. Studio 8 ft high 25 ft SW.
Hedge 3 " " 14 " E
House 20 " " 70 ft N.

Position of Station on reduced Ordnance Survey Map, 2 miles to 1 inch Series				No. of Map		Reference No.	
Date.	Lat. N.	Long.	Railway Station.	Distance from gauge	Direction	Parish Church.	Distance from gauge
1920			Plockton	1 1/4 mi	W	Plockton	1/4 mi W

RAINFALL at Inverinate, The Gardens, Loch Duich (Inverinate)

County of Ross & Cromarty Observer John Finlayson Esq.

River Basin 9/ Loch Canon, Loch Alsh etc.

Glaisher? Rain Gauge, by

Diameter	5"
Height	1' 0"
Altitude	28'
Year
	1920	1921	1922	1923	1924	1925	1926	1927	1928	1929	1930	
January	(13.45)
February	1.28
March	4.94
April	3.26
May	5.39
June	5.09
July	27.5
August	11.24
September	5.08
October	10.89
November	10.61
December	8.92
TOTALS	(82.90) D.

1930 This 12' high 27' w = N.
Wall 10" 51' E.
Wall 10" 90' S.

Position of Station on reduced Ordnance Survey } No. of Map..... Reference No.....
Map, 2 miles to 1 inch Series

Date.	Lat. N.	Long.	Railway Station.	Distance from gauge	Direction	Parish Church.	Distance from gauge	Direction
1930.			Kyle	15 miles	W	Hintail	3/4 mile	E.

Loch Carron.

RAINFALL at Strome ferry

County of Ross

Observer Mr. D. D. Munro.

River Basin Loch Carron, L. Alch. & E. - 9

(1926) N.O. Rain Gauge, by _____

Diameter ...				5					5		
Height				10							
Altitude ...											
Year	1920	1921	1922	1923	1924	1925	1926	1927	1928	1929	1930 MEANS.
January ...				11.00	6.82	6.89	10.01	10.67	13.34	1.70	11.43
February ...				3.76	4.74	6.39	4.86	2.99	7.73	1.29	.69
March				2.21	1.22	5.89	7.50	5.40	5.03	1.74	4.75
April.....				3.70	5.11	5.72	3.05	8.46	2.62	3.02	
May				4.67	2.93	6.07	4.27	3.48	1.01	3.89	3.86
June				5.39	5.64	2.34	2.96	5.07	4.67	4.14	4.90
July				6.08	5.31	2.79	2.91	3.04	6.30	4.01	2.33
August				8.87	5.09	3.82	6.41	4.97	4.52	7.45	10.46
September...				7.85	8.38	4.69	6.34	6.93	5.19	6.21	4.00
October.....				12.37	5.52	4.47	6.90	8.94	7.90	11.39	10.54
November...				6.76	4.96	3.33	7.04	6.41	8.64	8.45	7.25
December...				8.67	13.01	7.75	5.37	.21	8.02	9.93	6.75
TOTALS...				81.33 d	68.73 d	60.15 d.	67.62 d	66.57	74.97	63.22 v	66.96

Position of Station on reduced Ordnance Survey } No. of Map _____

Map, 2 miles to 1 inch Series

Reference No. _____

Date.	Lat. N.	Long.	Railway Station.	Distance from gauge	Direction	Parish Church.	Distance from gauge	Direction

Forestry Commission of Sweden

Rain Gauge, by

1922. G. on loan, 8/22.

Reference No.

[illegible]

County of Roe Observer Mrs. Campbell

River Basin Delaware, Fall C. 9

Rain Gauge, by

Diameter ...		5		5								
Height		1 0		1 0								
Altitude ...		9		9								
Year	1920	1921	1922	1923	1924	1925	1926	1927	1928	1929	1930 MEANS.	
January ...	(10.50)	13.71	6.76	14.41	5.49	6.92	8.63	10.74	12.87	1.58	10.19	10180
February ...	(9.50)	8.18	7.97	3.33	8.31	7.37	4.63	3.02	7.63	1.41	.87	6222
March	(8.00)	10.73	4.62	2.00	1.96	6.58	10.87	6.00	4.24	2.44	4.53	6197
April.....	(6.00)	3.38	4.26	4.18	5.07	6.04	3.40	11.18	3.03	4.40	2.99	5393
May	(6.40)	4.92	9.65	6.12	3.51	5.52	3.98	4.11	1.56	3.61	4.22	5360
June	(3.10)	2.95	5.31	5.85	6.90	3.27	3.90	5.54	5.02	5.14	4.69	5167
July	(6.00)	5.49	5.86	6.53	4.87	3.84	3.72	3.94	7.70	3.80	2.59	5434
August	(5.00)	3.95	4.36	9.27	6.64	3.75	5.87	4.49	4.66	8.17	11.51	6767
September...	(4.60)	5.34	3.23	7.77	7.54	6.74	7.27	8.33	4.89	8.30	3.93	6794
October.....	(2.50)	9.03	3.73	12.79	5.56	5.62	7.73	10.46	9.79	14.93	12.06	9420
November...	(11.20)	2.45	7.56	8.13	4.41	3.59	5.81	7.82	9.34	6.86	11.28	7845
December...	(7.20)	15.66	8.20	9.49	11.07	7.49	7.53	30	7.88	10.64	7.54	9300
TOTALS...	(8000) NR	85.79	71.51	89.87	71.33	66.73	73.34	75.93	78.61	71.28	76.40	84079

1301. Apples

*Position of Station on reduced Ordnance Survey
Map, 2 miles to 1 inch Series*

No. of Map.....

Reference No.

[illegible]

RAINFALL at Applecross Gardens

County of Ross Observer Mr. D. McCowan

River Basin Loch Carron, Loch Alsh & B. g.

(1926) no Rain Gauge, by _____

tw 1916-50 w.

Diameter ...	5"			5"					5"			
Height	1 0			1 0					1 6	1 6		
Altitude ...	70			70					70			
Year	1920	1921	1922	1923	1924	1925	1926	1927	1928	1929	1930. MEANS	Sums
January ...	8.00	8.37	7.65	8.20	5.02	6.86	7.27	8.95	10.83	2.97	5.94	80.06
February ...	7.38	2.60	7.57	3.52	4.50	7.35	4.84	3.97	4.56	1.30	.94	48.53
March	6.22	7.40	4.70	2.80	1.15	5.28	4.35	6.07	5.22	.72	3.95	47.88
April	4.60	3.20	5.70	4.53	4.10	4.40	4.54	7.78	3.94	3.56	2.44	48.74
May	4.92	3.77	5.33	7.75	3.03	5.15	4.75	3.75	2.40	3.59	2.42	46.86
June	2.37	2.33	3.72	3.72	4.86	2.25	2.48	5.61	3.77	3.72	3.18	38.01
July	4.65	3.65	4.03	5.10	4.38	2.72	4.52	3.59	4.83	3.43	1.38	42.28
August	3.88	3.50	4.56	7.05	7.45	4.14	4.05	4.65	3.03	5.98	7.04	55.33
September...	3.56	3.90	3.19	7.09	7.14	7.00	4.48	8.38	4.45	4.67	2.97	56.83
October	1.97	5.47	1.55	9.66	5.21	5.76	7.81	7.35	7.35	9.41	7.66	69.20
November...	8.62	2.05	4.72	7.85	4.21	3.75	6.24	5.20	6.26	3.42	3.12	55.44
December...	5.53	9.30	7.60	7.37	11.32	7.24	4.17	.21	6.45	7.41	5.05	71.65
TOTALS...	61.70	55.54	60.32	74.64	62.37	61.90	59.50	65.51	63.09	50.18	46.09	660.84

1920. Gauge on lawn surrounded by shrubs. (10ft high 18ft NW - 1921)
1922. Trees 40ft high 50ft N.
1929. Record low. Obs! will move 4. 30 yds. further from trees.
1930 year 5"-10" low. Mr. Edin have written re possible change in exposure or leak starting at end of 1929.

1927 should be about 98 percent
1930 - - - 90 percent
x143

Position of Station on reduced Ordnance Survey Map, 2 miles to 1 inch Series				No. of Map		Reference No.	
Date.	Lat. N.	Long.	Railway Station.	Distance from gauge	Direction	Parish Church.	Distance from gauge
1920			Hyle of Lochalsh	15 mi	S	Apperness	1 mi NW

RAINFALL at Glencarron Lodge

County of ROSS Observer Mr. D. D. Munro

River Basin Loch Carron, Loch Alsh & G.

Bradford Rain Gauge, by _____

Diameter ...	5										
Height	1 0										
Altitude ...	504										
Year	1920	1921	1922	1923	1924	1925	1926	1927	1928	1929	MEANS.
January ...	15.00	18.70					644	38			
February ...	17.90	8.50					101	97	—		
March	12.00	13.60					428	51	—		
April	5.40	3.80					264	70	—		
May	6.30	4.60					262	52	—		
June	2.20	5.70					344	97	—		
July	7.70	5.20					149	7	—		
August	10.75	4.60					963	7	—		
September...		6.80					322	19			
October		12.70					830	98	—		
November...	9.30	2.40					328	47			
December...	7.50	21.80	#				547	84	—		
TOTALS...	94.05	105.40					4992				

Position of Station on reduced Ordnance Survey } No. of Map _____ Reference No. _____
Map, 2 miles to 1 inch Series

Date.	Lat. N.	Long.	Railway Station.	Distance from gauge	Direction	Parish Church.	Distance from gauge	Direction
1913	57° 30'	5° 14'	Achnachellach					

RAINFALL at Stornoway - Leurbost School,

County of Ross & Cromarty Observer P.C. Copland, Esq.

River Basin Innular, Outer Hebrides 10. A. Matheson Esq.,

L.O. Matheson Rain Gauge, by (125)

Diameter ...					- 5	5"			5		
Height					- 6	6"			1		
Altitude ...						100'			150		
Year	1920	1921	1922	1923	1924	1925	1926	1927	1928	1929	1930 MEANS.
January ...					(4.50)	5.49	5.29	6.69	11.43		(6.57)
February ...					(3.00)	4.89	3.38	2.22	5.25		.30
March					#(4.40)	3.96	3.31	2.84	3.71		1.95
April					2.80	3.62	1.63	6.14	2.23		.96
May					2.30	3.80	2.69	1.45	1.80		1.74
June					2.83	.63	1.37	3.72	2.21		1.75
July					4.73	2.24	2.42	3.82	3.06		(1.40)
August					4.65	2.37	4.11	2.80	2.52		(2.47)
September...					4.29	3.46	5.97	5.49	2.82	4.68	2.44
October					4.39	4.51	4.13	7.25	4.64	6.87	8.80
November...					3.97	3.60	5.28	5.79	5.40	5.69	5.83
December...					8.15	5.15	4.42	86.	5.09	7.32	5.43
TOTALS...					(50.01)	43.72	44.00	49.07	50.16	imp.	(39.64) d.

1924. Jan - March... estd.

1925. Dwelling House, 15ft. high, 20 yds N.
Dyke, 4ft. high, 20 yds. E. S. W.

1929. Record lapsed. Restarted in Sept.

1930. ^{part} Aug. & whole July estimated by surrounding stns.
Jan. adjusted similarly

Position of Station on reduced Ordnance Survey } No. of Map _____ Reference No. _____
Map, 2 miles to 1 inch Series

Date.	Lat. N.	Long.	Railway Station Nearest Port	Distance from gauge	Direction from gauge	Parish Church.	Distance from gauge	Direction from gauge
1925	58° 8' 20"	6° 27' 30"	Stornoway	9 m	NNE	Keose	3 m.	SSW.

Observer Board of Northern Lights

Rain Gauge, by

Catechusin 1926 G. on level ground; wall to E 3 ft. high + 3 yds away; tower 6 ft. high to N; houses 13 yds to W. Standards, 10 ft. above ground.

Reference No.

(^o1383) Wt. 1671—6044. 10,000. 4/21. J. T. & S., Ltd. 160.

RAINFALL at Stornaway Lighthouse

County of ROSS Observer Board of Northern Lights

River Basin Insular, Outer Hebrides 10

Rain Gauge, by _____

Diameter ...	8										
Height	4 9										
Altitude ...	20										
Year	1920	1921	1922	1923	1924	1925	1926	1927	1928	1929	1930. MEANS.
January ...	6.66	6.24	4.46	3.95	3.67	5.50	5.17	6.99	10.78	1.70	6.30
February ...	5.62	1.69	3.68	3.44	2.10	5.13	3.09	2.19	5.21	1.49	.69
March	3.14	4.97	2.29	.67	2.65	3.62	3.83	2.70	3.40	1.12	2.36
April	1.65	1.56	2.20	1.85	3.36	3.09	1.96	6.73	2.23	1.58	1.75
May	3.69	2.69	3.57	2.48	2.21	3.86	3.32	1.30	1.64	2.34	2.10
June	1.39	1.28	1.81	2.08	2.45	.67	1.81	3.47	3.03	3.37	2.24
July	2.00	2.79	2.09	3.30	4.27	2.17	1.74	3.98	3.47	2.95	1.31
August	1.85	2.57	3.79	4.00	3.83	3.21	3.95	3.37	2.17	6.41	4.53
September...	3.13	4.02	2.08	4.87	4.56	3.22	6.14	6.01	2.92	5.35	2.06
October	2.02	3.87	1.87	6.41	4.02	4.39	4.07	7.50	4.59	6.82	7.10
November...	6.88	2.92	2.85	6.16	3.73	4.25	4.97	5.60	6.50	5.48	3.96
December...	3.86	5.70	4.60	4.39	8.39	4.86	4.63	.83	5.35	7.35	5.18
TOTALS...	41.79	40.30	35.29	43.60	45.24	43.97	44.68	50.67	51.29	45.96	39.58

Catchment in 1926. Ground level for 14 yds round S. S. in open field. Hill 50ft. high about 40ft. to the S.
Standard. rim 6 in. above ground.

Position of Station on reduced Ordnance Survey } No. of Map _____
Map, 2 miles to 1 inch Series

Reference No. _____

Date.	Lat. N.	Long.	Railway Station.	Distance	Direction	Parish Church.	Distance	Direction
				from gauge			from gauge	

RAINFALL at Stornoway, Hershader P. S. Lewis
County of Ross & Cromarty Observer P. Copland Esq
River Basin Insular, Outer Hebrides 10.
Rain Gauge, by _____

Diameter ...			5								
Height			1 0								
Altitude ...			50								
Year	1920	1921	1922	1923	1924	1925	1926	1927	1928	1929	MEANS.
January ...				3.95							
February ...				3.44							
March67							
April				1.85							
May			4.48	2.48							
June			2.80	2.08							
July			2.48	3.30							
August			4.28	4.00							
September...			2.72	4.87							
October			3.22	6.41							
November...			3.87	6.16							
December...			6.36	4.39	to Lumbost School.						
TOTALS...				43.60 ⁹							

1922. Dyke 4 ft high 107ds S. & W.
Fence 4 " " 10 " N & E.
1923. low.

Position of Station on reduced Ordnance Survey Map, 2 miles to 1 inch Series				No. of Map		Reference No.		
Date.	Lat. N.	Long. W.	Railway Station.	Distance from gauge	Direction	Parish Church.	Distance from gauge	Direction
1922	58° 5'	6° 31'				Keose P.C.	1½ mi	N 1½ E

RAINFALL at Stornoway

County of ROSS Observer Meteorological Office
H. Grant

River Basin Insular, Outer Hebrides 10

Rain Gauge, by _____

Diameter ...	8										
Height	1 0										
Altitude ...	52			51							
Year	1920	1921	1922	1923	1924	1925	1926	1927	1928	1929	1930. MEANS.
January ...	8.77	8.15	5.82	6.57	4.56	5.82	5.47	7.27	10.56	1.85	6.62
February ...	7.44	2.52	5.36	4.12	3.04	5.38	3.23	2.13	5.48	1.44	.74
March	5.01	6.69	3.13	1.27	4.41	3.93	4.34	2.82	3.48	1.23	3.07
April	2.96	2.50	2.56	2.98	2.87	3.79	2.32	6.47	2.44	1.59	1.99
May	5.21	3.02	4.86	3.21	3.06	3.67	3.45	1.81	1.81	2.22	2.48
June	1.51	1.96	2.73	2.64	3.33	.98	2.05	3.76	3.30	3.26	2.60
July	2.77	3.21	2.56	3.80	4.84	2.08	1.86	3.92	3.05	2.91	1.43
August	2.25	3.31	4.61	5.32	4.74	3.16	4.06	2.72	2.19	5.83	4.80
September...	4.26	4.64	2.76	4.95	5.25	3.88	6.62	6.12	3.03	6.19	2.79
October	2.66	4.78	3.07	7.45	4.96	4.73	5.75	7.37	5.07	7.61	7.91
November...	8.53	3.23	3.74	7.29	4.14	4.34	5.04	5.47	6.75	5.86	5.87
December...	4.99	8.66	5.88	5.57	9.23	5.74	5.27	1.17	5.53	7.69	5.44
TOTALS...	56.36	52.47	47.08	55.17	54.43	47.50	49.46	51.03	52.69	47.68	45.74

Nyd Sta. No. 89- 727447
NGR: NB (19) 428329
alt 9m

Position of Station on reduced Ordnance Survey } No. of Map _____
Map, 2 miles to 1 inch Series } Reference No. _____

Date.	Lat. N.	Long.	Railway Station.	Distance from gauge	Direction	Parish Church.	Distance from gauge	Direction

RAINFALL at Stornoway, P.uth of Lewis

County of ROSS Observer Board of Northern Lights

River Basin Insular, Outer Hebrides 10.

Rain Gauge, by _____

Diameter ...	8											
Height	4.6						3.9					
Altitude ...	170						51					
Year	1920	1921	1922	1923	1924	1925	1926	1927	1928	1929	¹⁹³⁰ MEANS.	
January ...	5.42	5.45	4.93	4.56	3.98	6.50	5.60	5.16	5.15	2.01	3.96	55.72
February ...	4.06	3.50	3.32	3.35	3.97	7.30	4.50	1.53	5.65	.74	.09	38.01
March	2.34	5.79	2.94	1.89	8.20	1.70	7.09	1.87	1.55	.69	3.13	37.19
April	1.25	2.15	1.32	1.47	1.53	3.50	.91	6.17	1.57	1.34	1.60	22.81
May	2.57	1.54	3.51	3.15	3.48	3.90	3.47	1.84	1.79	1.48	2.00	28.73
June	1.11	1.58	1.58	2.36	3.47	.50	.54	2.34	2.38	1.81	1.05	18.72
July	2.21	1.67	2.14	2.92	3.01	1.80	1.80	2.82	3.66	2.12	1.17	25.12
August	1.08	2.66	2.34	3.94	3.94	4.80	4.07	2.54	3.47	5.55	3.42	37.81
September...	2.33	3.34	2.05	4.35	2.65	5.10	5.96	5.62	2.57	4.21	2.10	40.28
October	1.72	4.80	1.65	7.03	.62	5.40	4.03	7.40	3.16	2.07	5.69	43.57
November...	6.35	2.03	3.18	5.85	.40	1.90	4.00	4.17	5.22	2.02	5.20	40.32
December...	3.24	4.16	4.41	5.39	.85	5.50	5.10	.44	4.06	4.44	4.62	42.21
TOTALS...	33.68	38.67	33.37	46.26	36.10?	47.90	47.07	41.90	43.23	28.48?	34.03	

1925. N.P. big.
Catechism 1926. Is on grass land surrounded by walls
and buildings. Boundaries from W to E slightly. House 13 yds to NE
+ 24 ft. high, houses 20 yds to NW + SE about 14 ft. high.
wall to SW. Is with cistern 3 ft 9 in. above ground.
1929. annual total 7 ins. low.

Position of Station on reduced Ordnance Survey } No. of Map _____ Reference No. _____
Map, 2 miles to 1 inch Series

Date.	Lat. N.	Long.	Railway Station.	Distance	Direction	Parish Church.	Distance	Direction
				from gauge			from gauge	

RAINFALL at Skibo Castle Gardens

County of Sutherland Observer K. D. Cameron

River Basin Dornoch Firth - 1

Rain Gauge, by

Diameter										5	
Height										10	
Altitude										62	
Year	1920	1921	1922	1923	1924	1925	1926	1927	1928	1929	1930
January										(.75)	(2.50)
February										(.60)	(1.00)
March										.14	1.15
April										.81	1.32
May										.89	1.68
June										1.00	1.60
July										.68	1.98
August										1.75	6.23
September										1.09	2.65
October										2.12	5.14
November										2.80	5.18
December										3.02	2.30
TOTALS										15.65	(32.73)

1929. Jan + Feb, est'd. Low. N. S.
1930 Jan - Feb estimated by surrounding stns.

Position of Station on reduced Ordnance Survey
Map, 2 miles to 1 inch Series

No. of Map

Reference No.

Date.	Lat. N.	Long.	Railway Station.	Distance from gauge	Direction from gauge	Parish Church.	Distance from gauge	Direction from gauge

RAINFALL at Saig

County of Sutherland Observer W. Macdonald Esq.

River Basin Gornoch Firth - 1. Alexander Gunn, Esq. ('25)

Snordon Rain Gauge, by _____

Diameter ...			5	5							
Height			1	0	1	0					
Altitude ...			330	330							
Year	1920	1921	1922	1923	1924	1925	1926	1927	1928	1929	1930 MEANS.
January ...				7.33	2.27	2.81	2.92	5.93	6.98	1.26	2.99
February ...				4.87	3.92	5.49	2.35	1.90	5.16	.74	1.58
March				0.60	1.75	2.89	5.90	2.30	2.53	1.59	1.87
April			2.68	3.23	1.91	2.85	2.41	5.23	1.30	2.16	1.34
May			3.32	3.75	2.29	2.90	2.87	1.91	1.39	2.07	1.99
June			1.75	1.36	2.43	.88	2.66	3.24	2.70	2.64	2.07
July			2.47	3.08	3.27	1.96	2.06	3.42	2.47	1.45	2.09
August			2.20	5.48	5.42	1.16	2.61	1.90	2.86	4.95	6.68
September...			2.12	3.55	4.44	2.54	2.98	4.83	1.57	3.75	2.87
October			1.45	5.43	3.36	3.19	4.61	4.73	4.41	4.78	5.98
November...			3.38	4.68	1.89	.86	4.15	4.07	4.70	3.55	6.60
December...			3.56	3.63	2.36	4.46	5.71	1.11	5.21	6.74	2.34
TOTALS...				46.99	35.31	31.99	41.23	40.57	41.28	35.68	38.40
			D	D	D	D	D	D	D	D	D

1923. Gauge moved 17th July, 1/4 mile to South.

House 35' high 25' to South.

123	93	84	108	
127	96	87	112	37.3
126	95	86	111	37.5
125	94	85	110	

Position of Station on reduced Ordnance Survey Map, 2 miles to 1 inch Series				No. of Map		Reference No.	
Date.	Lat. N.	Long.	Railway Station.	Distance from gauge	Direction	Parish Church.	Distance Direction from gauge
19 23			Saig	1 1/4 m	E	Free church	400 yds S.W.

RAINFALL at Dornoch St. Gilberts

County of Sutherland Observer G. J. Campbell Esq.

River Basin Fleet, Brora & C. 2. J. Mc Crone Esq. from May 1922

Lyman Rain Gauge, by

Diameter ...	5"										
Height	1.0										
Altitude ...	35		85								
Year	1920	1921	1922	1923	1924	1925	1926	1927	1928	1929	MEANS.
January ...	2.41	2.93	2.70	2.59							
February ...	1.61	.52	2.04	1.36							
March	1.64	2.06	1.75	1.56							
April	1.84	.80	2.19	2.41							
May	2.29	3.17	2.41	1.87							
June65	1.01	1.14	1.02							
July	2.06	2.35	2.61	2.62							
August	2.19	1.44	2.13								
September...	2.39	1.36	2.32								
October	1.66	2.09	.96								
November...	2.25	1.46	1.36								
December...	2.28	3.90	1.23								
TOTALS...	23.27	23.09	(22.84)	#							

1920. House 35 ft high 35 yds S.
1922. Gauge moved in May. to Strath Halladale.

Position of Station on reduced Ordnance Survey } No. of Map
Map, 2 miles to 1 inch Series

Reference No.

Date.	Lat. N.	Long. W	Railway Station.	Distance from gauge	Direction	Parish Church.	Distance from gauge	Direction
1920	57° 53'	4°	Dornoch	500 yds	N E	Cathedral	250 yds	E

RAINFALL at Golspie, Technical School

County of Sutherland

Observer E. R. Read Esq

River Basin Fleet, Brora & C. 2



London Rain Gauge, by Baird & Lalloch

(125)

(1926) Idowood (1928) Snowdon.

Diameter ...	5"	6"				6"	5"		6"		
Height	1' 9"					1' 9"			1' 2 1/2"	1' 2"	
Altitude ...	105'	100'				100'			100'		
Year	1920	1921	1922	1923	1924	1925	1926	1927	1928	1929	1930. MEANS.
January ...	3.36	4.66	2.83	4.14	2.23	3.37	3.11	2.58	4.16	.95	1.63
February ...	2.48	.77	1.69	3.16	2.70	5.99	3.46	1.40	2.16	.65	1.01
March	2.96	2.41	2.23	.60	1.39	4.21	5.05	1.44	1.77	.27	1.16
April	3.07	.76	4.23	4.05	1.23	3.04	2.12	3.56	1.23	2.70	1.49
May	3.36	2.30	2.80	4.62	4.08	3.42	3.10	1.96	1.91	2.64	2.12
June59	1.29	.91	.88	1.82	.95	1.95	3.42	2.85	2.78	1.68
July	1.95	3.39	3.14	(4.40)	(3.51)	(2.70)	1.42	1.45	2.76	1.51	1.90
August	1.72	2.16	1.56	(5.70)	(4.20)	(1.30)	2.87	2.35	2.81	4.70	(5.50)
September...	2.47	2.13	2.87	2.90	4.21	2.47	2.77	3.97	1.79	2.42	(2.54)
October	1.75	2.43	1.15	5.15	3.38	3.01	4.65	4.08	3.35	3.93	5.33
November...	2.41	1.79	2.24	4.41	2.76	1.73	3.42	2.92	3.84	2.20	4.16
December...	2.73	5.34	2.23	3.96	2.80	3.71	3.34	0.95	2.72	3.34	2.02
TOTALS...	28.85	29.43	27.88	43.97	34.31	35.90	37.26	30.08	31.35	28.09	30.54
	D	D	D	d	d	d	d	D	d	d	d

1920. Gable 40 ft high 33 ft N.

July & Aug. put est. 1923.

1925. July & Aug. est. d.

1930. Aug & Sept. allocated from 1928 & 1929.

Position of Station on reduced Ordnance Survey
Map, 2 miles to 1 inch Series

No. of Map

Reference No.

Date.	Lat. N.	Long.	Railway Station.	Distance from gauge	Direction	Parish Church.	Distance from gauge	Direction
1920	57° 58' 12"	4°	Golspie	1/2 mi	E	Golspie	1 1/4 mi	N E by E.

RAINFALL at Brona

County of Sutherland

Observer C. R. Akroyd Esq.

River Basin Fleet, Brona & C. 2

M.O. Rain Gauge, by

Diameter ...							5				
Height							0.6				
Altitude ...							60				
Year	1920	1921	1922	1923	1924	1925	1926	1927	1928	1929	MEANS.
January ...							2.23	2.70	4.52	1.06	#
February ...							2.50	1.52	3.17		
March							3.95	1.58	2.04		
April							2.01	3.42	.91		
May							2.72	2.05	1.19		
June							1.70	2.57	2.01		
July							1.58	1.94	2.51		
August							2.83	2.39	3.18		
September...							2.62	3.30	1.77		
October							4.56	4.01	3.22		
November...							2.71	2.65	4.15		
December...							3.34	1.12	3.20		
TOTALS...	25.97	26.34	24.47	33.02	28.21	26.37	32.75	29.25	31.87	3	

1920-25 entered 26.1x.28. see file 660628/26 (Enc. 67A)

Position of Station on reduced Ordnance Survey Map, 2 miles to 1 inch Series				No. of Map		Reference No.	
Date.	Lat. N.	Long. W	Railway Station.	Distance from gauge	Direction	Parish Church.	Distance from gauge
1927	58° 0' 40"	3° 51' 0"					

RAINFALL at Dunrobin Castle

County of Sutherland

Observer The Duke of Sutherland
W. F. Game

River Basin Fleet, Broca & C. 2.

Snawdon Rain Gauge, by

Diameter ...	5			5							
Height	1 6			1 0							
Altitude ...	14			14							
Year	1920	1921	1922	1923	1924	1925	1926	1927	1928	1929	MEANS.
January ...	2.81	4.28	4.13	3.56	1.93						
February ...	2.25	.82	2.04	1.69	2.28						
March	3.21	2.36	1.95	.66	1.81						
April	2.31	1.03	2.81	2.82							
May	2.97	2.69	2.72	3.31							
June65	1.09	1.34	.97							
July	1.49	2.39	2.27	3.44							
August82	2.03	1.51	4.61							
September...	3.01	1.94	2.38	4.01							
October90	2.50	1.09	4.46							
November...	2.34	2.02	2.05	2.48							
December...	2.42	5.50	1.71	3.29							
TOTALS...	25.18	28.63	26.00	35.30	imp.						

1920. New Gauge 1.14.20. 20 yds W.
Bushes 7 ft high 24 yds W.
'924. cannot extract any further information

Position of Station on reduced Ordnance Survey } No. of Map
Map, 2 miles to 1 inch Series

Reference No.

Date.	Lat. N.	Long. W.	Railway Station.	Distance from gauge	Direction	Parish Church.	Distance from gauge	Direction
1920	57° 57'	3° 59'	Golspie	1 3/4 mi	W	Golspie	3/4 mi	W

County of Sutherland Observer D. Macaulay.

River Basin Helmsdale - 3. W. Stalher
stationmaster, 1923.

Rain Gauge, by

Diameter ...				5.					5		
Height				10					1		
Altitude ...				120					120		
Year	1920	1921	1922	1923	1924	1925	1926	1927	1928	1929	1930 MEANS.
January ...				3.50	1.81	2.64	2.72	2.16	(4.50)	.79	
February ...				2.98	1.43	4.51	2.96	1.18	(2.50)	.64	
March64	1.92	2.50	2.95	1.63	1.90	.54	
April.....				2.67	1.84	1.92	2.56	3.96	1.26		
May				3.76	2.77	2.42	1.32		1.48		
June86	1.39	.56	1.99		2.18		
July				2.08	3.79	1.64	1.18		2.33		
August			# imp	5.48	2.12	1.52	1.69		3.10		
September...			3.30	2.91	3.55	1.60	2.58		2.17		
October.....			1.42	4.73	2.87	2.79	4.28		6.03		
November...			3.05	3.05	1.63	1.46	3.02		5.81		
December...			2.32	2.61	2.48	2.96	2.63		2.99		
TOTALS...				35.27	27.60 D	26.52 D	29.88 D	imp	(36.25)	imp X	imp.

1922: G. on loan 8/22
1927. Gauge leaking after April. until May 1928 at least.
1930 Edinburgh's note "This record is hopeless. the gauge was reported leaking. The Observer will not answer correspondence."

N.B. annual values reported from Survey Map 1929.
Position of Station on reduced Ordnance Survey Map, 2 miles to 1 inch Series } No. of Map _____ Reference No. _____

Date.	Lat. N.	Long.	Railway Station.	Distance from gauge	Direction	Parish Church.	Distance from gauge	Direction

RAINFALL at Forsinard Station.

County of Sutherland Observer A. G. Calder

River Basin North Coast - 4 W. Simpson. (1928).

M. G. Rain Gauge, by _____

Diameter ...									5		
Height									1'4"		
Altitude ...									505		
Year	1920	1921	1922	1923	1924	1925	1926	1927	1928	1929	1930 MEANS.
January ...									3.03	1.42	2.08
February ...									1.22	.73	(1.21)
March									1.41	.32	(1.13)
April.....									2.18	1.56	(1.25)
May									1.99	1.34	3.07
June									3.41	2.10	2.52
July									3.70	2.40	2.16
August									4.52	6.05	7.65
September...			2.69						2.03	5.21	3.56
October.....			2.62						4.29	6.55	4.84
November...									7.09	2.13	7.00
December...									3.06	6.27	(2.94)
TOTALS...									37.93	36.08	(39.41)

1922. G. on loan 8/22
1928. Gauge moved 30 yards E. in Jan. House 30' high 30 yds W
1928 Bad up.
1930 Feb. March, April - Dec^r adjusted.

Position of Station on reduced Ordnance Survey } No. of Map _____
Map, 2 miles to 1 inch Series } Reference No. _____

Date.	Lat. N.	Long.	Railway Station.	Distance from gauge	Direction	Parish Church.	Distance from gauge	Direction
1928.			Forsinard	50 yds.	S.	Strathay	20 m	N.W.

RAINFALL at *Borgie, Sherray*

County of Sutherland

Observer Wm. Mackay Esq

River Basin North Coast Streams 4.

Mr. C. Spence

Rain Gauge, by.....

Diameter ...							5				
Height							10				
Altitude ...							110				
Year	1920	1921	1922	1923	1924	1925	1926	1927	1928	1929	1930 MEANS.
January ...							1.65	4.03	7.32	2.24	3.88
February ...							1.86	1.22	3.91	.92	1.48
March							4.16	2.43	2.25	.96	3.71
April.....							1.74	5.79	1.84	2.21	1.58
May							2.18	2.67	2.01	2.31	2.76
June							2.76	4.62	3.58	3.37	2.86
July							2.09	1.85	2.46	1.82	3.66
August							2.54	2.59	2.32	5.06	5.63
September...							3.80	6.67	3.05	5.26	2.85
October.....							8.53	6.12	3.54	6.33	5.50
November...							3.19	4.74	5.47	3.35	8.92
December...							4.56	1.21	3.16	7.12	3.04
TOTALS...							39.06	43.94	40.94	40.95	45.87
							D	D	D	D	D

*Position of Station on reduced Ordnance Survey
Map, 2 miles to 1 inch Series*

No. of Map.....

Reference No.

[illegible]

RAINFALL at Tongue Manse

County of Sutherland Observer Rev David Lundie

River Basin North Coast Streams 4. m.g. a Sargent (1927)

Snowdon Rain Gauge, by Rev W. J. Lundie (1929)

Diameter ...	5			5							
Height	1 0			1 0							
Altitude ...	180			180							
Year	1920	1921	1922	1923	1924	1925	1926	1927	1928	1929	1930. MEANS.
January ...	3.66	5.29	3.78	4.44	2.49	4.35	2.67	4.51	7.61	2.08	3.73
February ...	4.68	1.34	1.65	2.59	3.21	5.21	2.33	1.25	4.39	.91	1.48
March	2.41	3.50	2.86	0.99	2.37	2.82	3.81	2.15	2.71	.58	3.48
April	3.10	1.39	4.41	4.22	2.51	3.09	1.91	4.97	1.81	2.14	.96
May	2.15	3.29	2.92	5.56	3.13	3.97	2.08	2.10	1.86	2.34	2.12
June	1.32	1.77	3.50	2.84	2.38	1.68	3.36	4.49	3.56	3.75	2.33
July	2.16	2.55	2.20	3.52	3.72	2.74	2.32	1.77	2.14	1.78	3.01
August	2.43	3.24	2.75	6.87	5.87	2.67	2.55	2.88	3.28	5.08	5.86
September...	3.85	4.59	2.35	3.35	6.32	5.25	3.50	5.71	2.57	4.77	2.63
October78	3.97	2.39	6.45	2.78	4.35	7.14	6.22	3.43	7.04	5.29
November...	4.08	2.14	3.03	4.67	2.00	3.22	3.04	4.83	5.42	3.21	7.41
December...	2.24	6.47	3.33	4.92	3.28	4.54	4.67	.90	3.44	6.20	2.78
TOTALS...	32.86	39.54	35.17	50.42	40.06	43.89	39.38	41.78	42.22	39.88	41.03.
	D	D	D	D	D	D	D	D	D	D	D

1920. Trees 12 ft high 27 ft W. others lower all round
1926. Gauge moved 11th Nov. to Tongue House 1 1/4 miles N.

Position of Station on reduced Ordnance Survey } No. of Map
Map, 2 miles to 1 inch Series

Reference No.

Date.	Lat. N.	Long. W.	Railway Station.	Distance from gauge	Direction	Parish Church.	Distance from gauge	Direction
1920	58° 28'	4° 25'	Paig	39 mi	S	Tongue	150 yds	NW

RAINFALL at Melrich Schoolhouse

County of Sutherland Observer Mr. A. MacIntosh, Esq.

River Basin North Coast Streams 4.

Rain Gauge, by _____

Diameter ...	5			5							
Height	1. 0			1 0							
Altitude ...		200		200							
Year	1920	1921	1922	1923	1924	1925	1926	1927	1928	1929	1930. MEANS.
January ...	4.80	4.54	4.06	4.38	2.47	3.27	1.78	2.97	5.03	2.40	5.00
February ...	3.10	.95	2.20	3.24	3.78	3.88	1.89	1.74	3.43	.76	2.20
March	2.40	1.88	3.07	.61	2.40	3.54	3.42	1.91	1.92	1.05	3.05
April	2.34	1.04	3.77	2.20	2.39	2.08	1.72	3.61	1.38	2.55	1.20
May	2.97	2.29	2.16	3.95	2.36	2.38	2.62	2.62	1.43	2.57	3.14
June	1.25	1.62	2.30	3.13	2.08	1.03	1.81	3.35	4.27	5.20	2.50
July	1.79	2.15	3.17	4.26	3.29	2.75	1.65	1.70	2.85	1.90	2.55
August	1.14	2.68	3.00	5.68	4.44	2.32	3.05	1.55	2.51	7.41	12.50
September...	3.24	3.98	2.62	3.96	5.80	5.19	3.15	4.76	2.82	8.14	3.44
October55	3.92	1.33	5.57	1.99	4.07	6.71	5.62	4.29	8.26	5.79
November...	3.93	2.28	3.14	5.47	2.13	3.22	2.67	5.11	5.74	4.95	9.88
December...	1.58	6.94	3.01	4.83	2.21	4.66	4.20	.94	6.58	12.69	4.11
TOTALS...	29.09	34.27	33.83	47.28	35.34	38.39	34.67	35.91	42.25	57.88	55.36. D. 4.49.

1920: G. & glass both damaged. New glass VI/21 (for 34809.)
1926. Mr MacIntosh retired 1.VI.26 to "The Cottage", 700 yds. from the Schoolhouse
no appreciable change of height.
1929. N. P. - leak.
1930. N.P. leak. (for glass & pool considers 1931 still OK.)

Position of Station on reduced Ordnance Survey } No. of Map _____ Reference No. _____
Map, 2 miles to 1 inch Series

Date.	Lat. N.	Long.	Railway Station.	Distance from gauge	Direction	Parish Church.	Distance from gauge	Direction

Rain Gauge, by.....

1922. Short-
Ca

(^o1383) Wt. 1671—6044. 10,000. 4/21. J. T. & S., Ltd. 160.

RAINFALL at Loch More, Achpary

County of Sutherland

Observer Mr. J. Munro

River Basin Loch Laxford &c 5

Rain Gauge, by H. & J.

Diameter ...	5			5									
Height	1 0			1 0									
Altitude ...	137			137									
Year	1920	1921	1922	1923	1924	1925	1926	1927	1928	1929	1930 MEANS.	Sums	
January ...	11.57	14.63	6.12	14.68	7.68	9.01	6.95	12.14	13.77	2.97	10.02	109.54	
February ...	12.08	6.31	6.05	4.58	8.37	10.47	3.57	2.66	9.38	1.98	1.91	67.36	
March	6.85	12.10	7.05	1.09	3.11	8.24	14.75	5.36	3.66	1.97	5.67	69.85	
April	7.44	4.94	6.08	3.65	5.74	5.31	3.66	15.37	3.00	4.54	2.97	62.70	
May	5.56	4.77	7.97	11.11	3.60	5.15	3.33	5.42	3.66	2.56	5.39	58.52	
June	2.21	4.29	5.69	11.48	5.41	4.37	3.65	7.30	5.47	6.92	5.25	62.04	
July	4.81	6.43	3.77	8.20	6.20	4.10	3.00	2.25	8.78	4.09	2.71	54.34	
August	3.89	4.77	5.58	8.09	7.82	5.13	8.94	5.65	5.52	9.46	9.64	74.49	
September...	6.70	8.66	4.81	9.30	8.58	11.61	8.27	10.37	4.69	11.80	4.76	89.55	
October	1.40	11.23	3.98	12.36	7.02	9.62	10.18	10.53	6.88	14.76	11.20	99.16	
November...	10.61	2.87	9.93	11.59	5.68	4.89	7.06	8.34	13.01	9.45	13.61	97.04	
December...	3.77	16.87	9.56	12.09	9.97	9.02	16.12	1.33	8.37	11.20	8.00	106.30	
TOTALS...	76.89	97.87	76.59	108.22	79.18	86.92	89.48	86.72	86.19	81.70	81.13	950.89	
	D	D	D	D	D	D	D	D	D	D	D		

1921. Loch 200 yds from gauge. Bunkers 6 ft. high 40 yds. S.E.
Stone 20, 50, S.W.
New dam 1 1/2 ft (fig 34809)

Position of Station on reduced Ordnance Survey
Map, 2 miles to 1 inch Series

No. of Map

Reference No.

Date.	Lat. N.	Long.	Railway Station.	Distance from gauge	Direction from gauge	Parish Church.	Distance from gauge	Direction from gauge
1911			Lairg	32	S.E.	Eddrachillies	17	W
1922						Scourie	14	W

County of Sutherland Observer W. Morrison, Esq. died 1/27.

River Basin Enard Bay. 6

Rain Gauge, by _____

Diameter ...						5"					
Height						1' 0"					
Altitude ...						235'					
Year	1920	1921	1922	1923	1924	1925	1926	1927	1928	1929	MEANS.
January ...						5.43	5.90				
February ...						8.18	2.41				
March						6.59	8.10				
April						4.38	3.10				
May						4.31	2.37				
June						2.46	2.90				
July						2.90	3.35				
August						2.72	6.14				
September...						11.73	6.11				
October						8.21	(9.00)				
November...						3.52	(5.00)				
December...						6.17	(7.00)				
TOTALS...						66.60	(61.38) //				

1926. Oct. Nov. + Dec. interpolated. m. G. Edinburgh.

N.B. Annual values rejected from Surrey Map. 1929.

Position of Station on reduced Ordnance Survey Map, 2 miles to 1 inch Series				No. of Map		Reference No.	
Date.	Lat. N.	Long.	Railway Station.	Distance from gauge	Direction	Parish Church.	Distance from gauge

RAINFALL at Stour Head

County of Sutherland Observer Board of Northern Lights

River Basin Enard Bay 6.

Rain Gauge, by _____

Diameter ...				5							
Height				10							
Altitude ...				170							
Year	1920	1921	1922	1923	1924	1925	1926	1927	1928	1929	1930 MEANS.
January ...	4.45	4.30	2.26	3.46		2.75	4.02	4.36	5.04	1.48	2.79
February ...	5.04	.87	2.59	2.07		1.76	2.40	1.24	1.98	.60	.28
March	1.94	3.11	2.10	.20		1.96	2.13	2.88	1.42	.55	1.93
April	1.80	.88	1.38	.73		1.90	1.35	5.48	1.45	.93	1.01
May	2.56	2.14	3.11	1.76	1.03	2.65	1.88	1.66	.83	.98	.85
June	1.09	2.05	1.48		2.69	1.21	2.17	2.52	1.84	2.85	1.62
July	3.02	2.03	1.57		3.16	2.28	1.65	2.51	3.28	2.02	.86
August	1.17	.95	2.50		3.37	2.58	3.14	1.24	2.04	4.33	4.21
September...	3.12	2.62	1.69		3.83	3.85	4.40	4.31	1.95	3.42	1.25
October83	3.98	1.88		3.24	3.80	4.71	4.50	2.70	3.56	3.48
November...	4.01	.73	2.86		2.57	3.46	3.22	3.04	2.99	2.65	3.51
December...	2.34	3.95	2.00		4.50	4.13	2.20	.25	2.41	2.62	2.80
TOTALS...	31.37	27.61	25.42			32.33	33.27	33.99	27.93	25.99?	24.59?

batechism 1926, 8. situated 26 yds from tower + house to N of
23ft high + 56 ft. long; 23 yds from cliff; (from W by N to E)
slight slope all round.
"glassie" 8 5 in. in diam + rim 10 in. above ground.
1929. annual Total = 10" low
1930. Annual Total 5"-10" low.

Position of Station on reduced Ordnance Survey Map, 2 miles to 1 inch Series				No. of Map		Reference No.	
Date.	Lat. N.	Long.	Railway Station.	Distance	Direction	Parish Church.	Distance
				from gauge			from gauge

RAINFALL at *Barriedale, Langwell Gardens*

County of *Cairnness* Observer *Mr. J. Murray* (Gauge —)

River Basin *Barriedale, Dunkeld & Co. 1. Duke of Portland (1929)*

Rain Gauge, by _____

Diameter ...		5									
Height		1	6								
Altitude ...		150									
Year	1920	1921	1922	1923	1924	1925	1926	1927	1928	1929	1930- MEANS.
January ...		1.81	2.56							1.46	1.99
February65	2.06							(1.18)	1.35
March		1.87	1.15							(1.00)	2.08
April.....		(1.00)	1.98							3.05	2.26
May		(2.50)	(1.67)							2.37	1.94
June		(1.10)	(1.58)							.15	1.58
July		3.00	(2.63)							3.10	1.51
August		3.23	1.27						3.00	4.49	5.69
September...		2.78	(2.52)						2.22	4.84	3.74
October.....		3.34	(1.55)						2.64	6.13	4.35
November...		2.01	2.48						4.85	2.44	6.30
December...		4.32	(2.37)						1.49	4.45	1.90
TOTALS...		(27.61) d	(23.82) d						Imp.	34.66 v	34.69

1921. Apr-June estd.
1922. not-printed. May, June, July, Sept. Oct. & Dec. estd.

Position of Station on reduced Ordnance Survey Map, 2 miles to 1 inch Series				No. of Map		Reference No.	
Date.	Lat. N.	Long.	Railway Station.	Distance	Direction	Parish Church.	Distance Direction
				from gauge			from gauge
1929.			Kelmsdale	6 1/4 m.	Sw.	Barriedale	1/2 m. N.E.

River Basin Perriedale, Dumbeth & Co.

Rain Gauge, by

Catechism 1926. B. on ground sloping up to NW, hill top 15 yds from gauge + 10 ft. higher than gauge. B. outside boundary wall + 18 yds from it - to SW, dwelling house beyond. To SE + NE road 11 yds from gauge + further to SE ground slopes down to cliffs.
B. standard trim $16\frac{1}{2}$ in. above ground.

Reference No.

(*1383) Wt. 1671—6044. 10,000. 4/21. J. T. & S., Ltd. 160.

Rain Gauge, by

(*1383) Wt. 1671—6044. 10,000. 4/21. J. T. & S., Ltd. 160.

RAINFALL at Wick, Rosshoad

County of Caitness Observer Board of Northern Lights

River Basin Wick & L. 2

Rain Gauge, by _____

Diameter ...	7						5				
Height	4 7						0 . 9				
Altitude ...	175						129				
Year	1920	1921	1922	1923	1924	1925	1926	1927	1928	1929	1930. MEANS.
January ...	2.60	1.54	3.25	3.67	1.40	1.55	2.10	2.12	6.40	.79	1.78
February ...	1.58	.89	1.86	2.62	1.61	1.75	2.19	2.41	1.89	1.12	.93
March	2.51	1.06	1.36	.55	1.52	1.61	2.80	1.37	.95	.62	1.68
April	1.68	.82	2.39	1.86	1.21	1.37	(2.87)	5.18	.97	.77	1.20
May	2.32	1.59	2.22	3.18	1.48	2.20	1.86	1.39	1.65	1.91	1.31
June79	.88	1.48	1.40	1.16	.97	(1.63)	2.11	2.56	2.96	2.59
July	1.67	1.72	2.23	1.93	3.23	2.13	(1.45)	.59	2.22	.78	1.12
August92	2.09	2.12	2.93	2.12	1.62	1.84	.71	1.82	4.62	5.83
September...	2.42	2.49	2.70	3.16	4.28	2.38	2.86	2.21	1.83	4.13	3.45
October86	1.86	1.13	4.20	1.90	2.36	(6.25)	4.75	3.93	4.21	3.34
November...	2.69	1.82	3.00	3.76	1.49	1.72	(2.42)	2.37	4.17	2.96	3.51
December...	2.67	3.63	2.52	3.66	1.19	1.93	(3.68)	.42	3.59	4.74	1.91
TOTALS...	22.71	20.39	26.26	32.92	22.59	21.59	31.95	25.63	31.98	29.61	28.65

1926. Apr. June, July, Oct. Nov. Dec. adjusted by sur. stat.
Collection 1926 S. in centre of garden on level ground.
Garden 28x28 yds. Surrounding walls 6ft. high. Site of S. is near
edge of cliff 90ft. above sea level. During the winter months a
considerable amt. of salt spray gets into the gauge.
"Blowholes" 5 in. in diam & run 9 in. above ground

Position of Station on reduced Ordnance Survey } No. of Map _____ Reference No. _____
Map, 2 miles to 1 inch Series

Date.	Lat. N.	Long.	Railway Station.	Distance Direction from gauge	Parish Church.	Distance Direction from gauge

RAINFALL at Altnabreac River Station

County of Caithness Observer George Strachan
Station Master
River Basin Thurso - 3 George MacLennan ('15)
Rain Gauge, by _____

Diameter ...				5							
Height				1							
Altitude ...				500							
Year	1920	1921	1922	1923	1924	1925	1926	1927	1928	1929	1930 MEANS.
January ...				2.99	1.92	1.87	3.50	2.49	4.56	1.75	2.05
February ...				4.49	1.74	4.57	2.55	1.44	1.57	.87	1.34
March				1.17	1.46	2.61	2.02	1.90	2.92	.50	1.11
April				3.07	1.52	2.24	3.53	3.77	1.34	1.68	1.34
May				4.84	4.13	3.06	3.36	2.32	1.71	1.41	2.09
June				1.59	1.75	.39	2.54	3.59	2.93	3.35	2.59
July				2.27	3.59	2.81	1.85	.90	2.10	2.12	1.87
August				5.49	3.32	1.59	2.01	3.06	3.73	6.01	7.41
September...				3.43	5.01	4.55	2.46	5.72	2.03	4.88	2.96
October				4.98	2.07	4.19	6.34	5.42	3.53	5.94	4.61
November...			2.66	2.88	2.12	2.32	4.08	4.52	4.34	2.91	4.83
December...			2.37	3.00	2.17	3.74	3.69	1.60	(3.38)	7.08	3.36
TOTALS...				40.22	30.80	33.94	37.93	36.73	34.14	38.50	35.56

G. issued on loan 8/22
1929. Sept. 17 corrected by Obsr

Position of Station on reduced Ordnance Survey Map, 2 miles to 1 inch Series				No. of Map		Reference No.	
Date.	Lat. N.	Long.	Railway Station.	Distance from gauge	Direction	Parish Church.	Distance Direction from gauge

RAINFALL at Thurso, Puckies

County of Caithness

Observer J. H. M. Davidson Esq

River Basin Thurso & C 3

Snowdon Rain Gauge, by

Diameter ...	5"			5							
Height	0. 11			-10 1/2							
Altitude ...	240			240							
Year	1920	1921	1922	1923	1924	1925	1926	1927	1928	1929	1930. MEANS.
January ...	4.28	5.31	4.53	3.81	2.67	3.33	2.66	3.15	4.59	2.15	2.59 3907
February ...	2.69	1.43	2.33	3.49	2.70	4.00	2.52	2.27	3.11	1.08	1.37 2699
March	3.05	2.87	2.39	6.7	2.53	3.36	3.76	2.57	2.20	.90	3.18 2748
April	2.98	1.57	3.98	2.70	1.63	2.00	2.29	4.55	1.33	1.73	1.32 2608
May	3.58	2.92	2.20	3.73	2.37	2.08	2.65	2.04	2.15	1.63	2.90 2825
June	1.31	2.05	2.43	2.57	1.59	1.06	2.29	5.11	3.89	3.74	2.70 2874
July	2.76	2.29	3.23	2.71	3.35	2.82	1.87	.86	3.68	1.83	4.26 2966
August	1.76	3.60	2.35	4.84	3.56	2.08	2.10	2.08	2.60	6.05	7.77 3879
September...	4.42	3.97	2.77	4.29	5.62	5.83	3.80	3.81	2.50	5.08	3.84 4593
October	1.13	3.76	1.79	5.77	2.48	4.19	6.88	5.49	3.06	6.24	4.43 4522
November...	3.52	2.61	2.82	5.27	2.17	4.06	3.15	3.86	5.58	4.21	5.79 4304
December...	2.82	6.29	3.01	4.79	1.98	4.05	5.36	1.05	5.05	8.45	3.14 4599
TOTALS...	34.30	38.67	33.83	44.64	32.65	38.86	39.33	26.84	39.74	43.09	43.29 42524

1920. Whin 2ft high 7ft circular

Position of Station on reduced Ordnance Survey } No. of Map
Map, 2 miles to 1 inch Series

Reference No.

Date.	Lat. N.	Long.	Railway Station.	Distance from gauge	Direction	Parish Church.	Distance from gauge	Direction
1920			Thurso	3 1/2 mi	N	Thurso	3 1/2 mi	N

Rain Gauge, by

1930. Low mfr.

Reference No.

RAINFALL at Dunnet Head

County of Caithness

Observer Board of Northern Lights

River Basin Thurso & C. 3.

Rain Gauge, by _____

Diameter ...	3						5				
Height	1.0						1.0				
Altitude ...	246						331				
Year	1920	1921	1922	1923	1924	1925	1926	1927	1928	1929	1930. MEANS-
January ...	4.71	5.53	4.75	5.03	3.47	2.45	2.38	2.95	4.02	1.03	2.89
February ...	3.16	1.46	3.29	3.65	2.43	3.69	2.52	1.72	.23	1.49	1.00
March	2.69	2.54	1.82	.50	2.00	2.26	4.10	2.30	.38	.48	1.37
April	2.04	.76	3.62	2.20	1.50	2.22	2.19	4.80	.72	1.21	1.27
May	3.33	3.90	2.51	2.98	1.24	1.96	1.55	1.20	.70	1.59	1.18
June89	1.59	2.40	2.78	2.53	1.22	1.69	3.52	1.37	4.78	1.95
July	2.31	2.76	2.43	3.27	2.53	1.86	1.02	.24	1.92	1.91	1.97
August	1.74	2.72	2.85	4.72	3.09	1.69	2.60	1.43	.98	5.06	6.78
September...	3.50	4.42	3.55	5.22	5.89	3.65	3.92	2.25	2.10	5.33	3.44
October40	4.00	1.69	7.88	2.90	4.83	6.38	3.85	2.15	3.58	4.65
November...	4.53	2.33	2.85	4.47	2.79	2.52	3.43	2.03	2.79	3.89	3.99
December...	1.93	6.13	3.68	4.58	1.65	1.99	4.43	.05	2.09	8.09	3.89
TOTALS...	31.23	38.14	35.44	47.28	32.02	30.34	36.21	26.34	19.45	38.44	34.38

Catchment 1926 5. on ground sloping to N. lighthouse tower
60 yds WNW on lower ground, height above rain-gauge about 30 ft.
Standard 5. with run 12 in - above ground

Position of Station on reduced Ordnance Survey } No. of Map _____ Reference No. _____
Map, 2 miles to 1 inch Series

Date.	Lat. N.	Long.	Railway Station.	Distance from gauge	Direction	Parish Church.	Distance from gauge	Direction

RAINFALL at Duncansby Head

County of Gaithness Observer Comms. of Northern Lighthouses

River Basin Thurso Hb. 3.

Rain Gauge, by _____

Diameter ...							5				
Height											
Altitude ...									196'		
Year	1920	1921	1922	1923	1924	1925	1926	1927	1928	1929	¹⁹³⁰ MEANS.
January ...						2.65	2.58	2.81	5.99	1.20	2.39
February ...						3.03	1.92	2.04	2.27	1.07	.98
March						2.48	2.56	2.19	1.77	.85	1.71
April					1.41	1.67	1.63	4.48	1.97	.91	1.72
May					2.90	2.20	1.06	1.80	1.50	1.84	1.22
June					1.42	1.11	.90	3.60	2.53	2.72	2.07
July					2.68	1.67	1.10	1.07	2.33	1.15	1.61
August					2.96	2.19	1.98	1.44	1.92	5.24	4.91
September...					5.70	3.51	3.66	4.11	3.00	4.26	4.22
October					2.30	3.41	6.36	6.43	3.38	4.13	4.16
November...					1.70	1.53	2.58	4.43	3.81	3.97	3.41
December...					1.36	1.76	3.80	1.57	3.75	5.35	2.38
TOTALS...					imp.	27.21	30.13	35.97	34.22	32.69	30.78

Position of Station on reduced Ordnance Survey } No. of Map _____ Reference No. _____
Map, 2 miles to 1 inch Series

Date.	Lat. N.	Long.	Railway Station.	Distance from gauge	Direction	Parish Church.	Distance from gauge	Direction

RAINFALL at Reay The Manse

County of Caithness

Observer Rev. Dugald Carmichael

River Basin Forss & C. 4

Rain Gauge, by _____

Diameter ...	8			8								
Height	1 0			1 0								
Altitude ...	49			49								
Year	1920	1921	1922	1923	1924	1925	1926	1927	1928	1929	1930 MEANS.	
January ...	4.34	4.41	3.86	4.74	2.63	3.39	2.21	2.96	5.53	2.07	2.47	3861
February ...	3.23	1.37	2.01	4.31	3.03	4.11	1.65	1.84	3.37	.96	1.84	2722
March	2.84	2.72	2.00	.59	3.10	2.89	3.07	2.55	2.04	.53	2.87	2520
April	2.39	1.14	3.78	2.51	2.22	2.17	2.05	4.21	1.50	2.18	.98	2513
May	3.18	2.67	1.82	3.79	2.29	2.24	2.07	2.03	1.26	2.02	1.87	2524
June	1.43	1.61	2.45	3.09	1.86	1.09	2.03	4.29	2.94	3.73	2.26	2678
July	1.95	1.97	2.98	3.23	3.16	2.47	1.92	.91	2.67	1.66	1.90	2432
August	1.78	3.09	2.93	6.02	3.55	2.10	2.33	2.03	2.25	4.39	7.74	3821
September...	4.03	3.93	2.48	3.94	5.11	5.59	3.05	4.76	2.60	4.04	2.80	4233
October	1.14	4.20	1.67	6.07	2.24	4.62	6.64	5.54	3.11	5.49	4.60	4532
November...	3.72	2.39	3.14	5.52	2.30	2.80	3.50	4.50	4.29	3.08	6.26	4150
December...	2.08	6.08	3.23	4.64	2.12	4.04	4.52	1.12	3.25	8.74	3.15	4297
TOTALS...	32.11	35.58	32.35	48.45	33.61	37.51	35.04	36.74	34.81	38.89	38.24	40333
	D	D	D	D	D	D	D	D	D	D	D	

2722

Position of Station on reduced Ordnance Survey } No. of Map _____ Reference No. _____
Map, 2 miles to 1 inch Series

Date.	Lat. N.	Long. W.	Railway Station.	Distance from gauge	Direction	Parish Church.	Distance from gauge	Direction
1920	58°33'	3°46'	Thurso	11 mi	E	Reay	300 yds	W

Rain Gauge, by

Catechism 1926 g. in front of dwelling houses, about 26 ft. from wall
+ 6 ft. from boundary wall which is 2 ft 6 in. high with iron railing on
top. In stormy weather gauge may contain as much salt water as
rain water. Standard gauge with rim 3 ft. above ground.
g. fixed in concrete & cannot be removed. File 55 3298/24 14A.

Reference No.

(*1383) Wt. 1671—6044. 10,000. 4/21. J. T. & S., Ltd. 160.

Observer Board of Northern Lights

River Basin Yuba 5

Rain Gauge, by

1924. N.P. bad.

Catechism 1926 Is. in garden enclosed by a wall 7 ft. high
nearest wall 5 ft. SW of gauge, site is quite level. Wall to N 85 ft;
to E 112 ft; to S 89 ft; to W 66 ft. Glasher gauge 5 in. in diam
+ rim 3 ft. above ground. In winter island swept by sea spray.
+ residue run to 12 above ground Oct. 26.

Mo. Edin Instructions given to reduce run to 12 above ground Oct. 20

*Position of Station on reduced Ordnance Survey
Map, 2 miles to 1 inch Series*

No. of Map.....

Reference No.

[illegible]

RAINFALL at Hoy Gantickhead

County of Orkney

Observer Board of Northern Lights

River Basin _____

Rain Gauge, by _____

Diameter ...	3						5				
Height	1 0						3 . 10				
Altitude ...	115-						68				
Year	1920	1921	1922	1923	1924	1925	1926	1927	1928	1929	1930. MEANS.
January ...	3.65	3.56	3.13	6.07	3.45	3.11	3.47	3.42	6.44	1.12	2.75
February ...	3.06	1.78	2.53	4.14	3.38	2.79	3.34	1.99	3.47	1.11	1.17
March	2.67	2.63	1.90	.79	1.28	2.90	4.40	2.68	1.85	.80	2.89
April	1.72	1.52	2.61	3.15	2.03	2.16	2.16	4.78	1.25	1.12	1.33
May	2.75	1.51	1.96	3.69	1.64	2.00	1.26	1.59	1.33	1.41	1.76
June53	1.39	1.52	2.51	1.46	.86	1.18	3.25	1.35	3.24	2.78
July	1.40	2.14	2.46	3.37	2.48	1.72	.98	.86	2.33	1.45	2.22
August73	1.56	2.10	4.13	2.93	1.82	2.56	1.49	1.43	7.15	5.75
September...	2.61	2.77	1.92	4.58	5.10	2.51	4.56	2.64	2.36	4.17	4.26
October65	3.39	1.88	6.56	3.22	5.20	5.06	6.02	2.99	4.26	5.44
November...	2.98	2.20	3.84	5.44	3.46	1.47	3.18	3.51	4.55	5.13	4.54
December...	2.28	4.78	4.83	4.42	1.71	3.23	6.03	1.43	3.57	8.59	2.96
TOTALS...	25.03	29.23	30.68	48.85	32.14	29.77	38.18	33.66	33.22	39.55	87.85

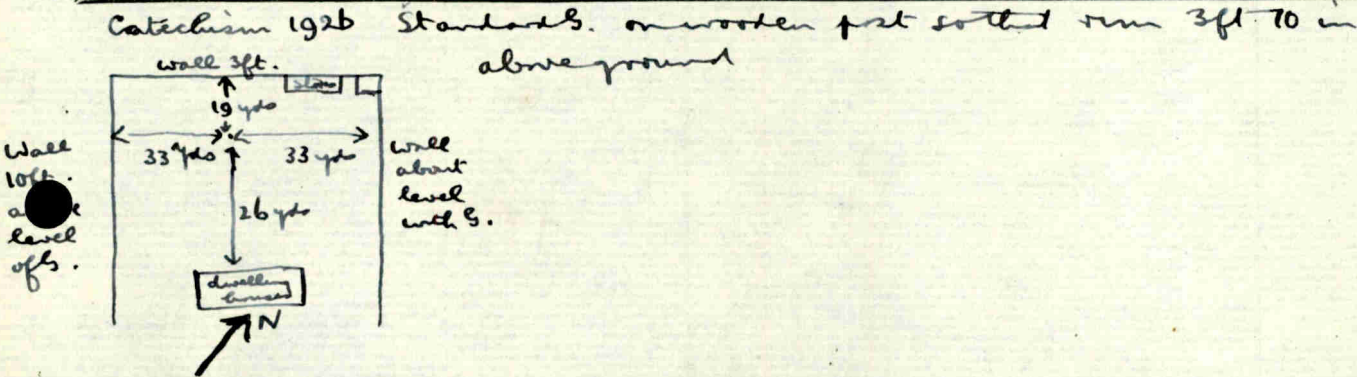

Position of Station on reduced Ordnance Survey Map, 2 miles to 1 inch Series } No. of Map _____ Reference No. _____

Date.	Lat. N.	Long.	Railway Station.	Distance from gauge	Direction	Parish Church.	Distance from gauge	Direction

RAINFALL at Hoy, Graemesay Sound, ~~High~~ High.

County of Orkney

Observer Board of Northern Lights

River Basin

Rain Gauge, by

Diameter ...	5"										
Height	0 4						1 4				
Altitude ...	115						40' 29				
Year	1920	1921	1922	1923	1924	1925	1926	1927	1928	1929	1930. MEANS.
January ...	3.48	4.09	2.26	3.92	3.46	3.39	3.97	1.92	6.00	1.25	3.13
February ...	5.20	1.03	2.02	2.87	3.27	4.21	2.80	.97	3.92	.82	1.29
March	3.34	2.62	2.25	1.14	2.50	2.15	4.92	3.65	2.19	.38	2.53
April	1.65	1.08	2.09	2.69	2.10	2.70	1.19	4.53	1.66	2.10	1.62
May	3.51	1.65	2.83	2.47	1.57	2.01	1.05	1.83	1.78	2.47	2.95
June32	1.55	1.88	2.02	1.15	1.13	1.09	2.57	2.45	2.76	1.85
July	2.32	2.17	2.75	3.30	1.62	1.74	1.02	.48	2.37	1.45	1.76
August80	2.24	2.44	3.74	4.01	1.27	2.14	1.01	1.12	4.31	5.54
September...	1.21	2.85	2.31	4.74	3.23	3.63	3.96	3.15	3.43	6.00	3.51
October62	3.01	1.75	6.97	3.22	4.24	7.27	4.72	4.23	6.64	5.50
November...	3.95	2.21	3.13	5.71	2.80	1.44	4.73	4.73	5.43	4.41	5.31
December...	2.70	4.33	4.26	4.66	3.37	2.72	4.18	.57	4.11	5.89	3.52
TOTALS...	29.10	28.83	29.97	44.23	32.30	30.63	38.32	30.13	38.99	38.48	38.51

Catechism 1926: Is in centre of garden about 56 yds square + surrounded by wall 7ft. high. "Blasberg". 5 in. in diam + 16 in. above ground.

Position of Station on reduced Ordnance Survey } No. of Map
Map, 2 miles to 1 inch Series

Reference No.

Date.	Lat. N.	Long.	Railway Station.	Distance	Direction	Parish Church.	Distance	Direction
				from gauge			from gauge	

Observer Board of Northern Lights

Rain Gauge, by

Catechism 1926 1/2 in. centre of garden 54 yds square, ground level
+ surrounded by walls 7 ft. high.
1/2 in. with side-tube + run 4 ft. 4 in. above ground.
Mo. Edm. new 5 in. gauge installed Dec. 26.

Reference No.

[illegible]

RAINFALL at Copinsay

County of Orkney

Observer Board of Northern Lights

River Basin _____

Rain Gauge, by _____

Diameter ...				5							
Height				10							
Altitude ...				210							
Year	1920	1921	1922	1923	1924	1925	1926	1927	1928	1929	1930, MEANS:
January ...	2.30	2.32	3.36	2.47	1.90	1.88		2.33	2.71	1.84	1.27
February ...	2.53	.86	1.19	1.30	1.68	2.24		1.30	1.78	1.42	.19
March	2.26	1.61	.75	.55	1.13	1.57		1.26	.77	.79	.30
April	1.68	.99	1.94	1.59	1.29	1.04		3.24	1.13	.96	.76
May	2.54	1.43	1.61	2.44	.98	1.81		.91	.93	1.55	1.07
June32	1.38	1.13	1.12	1.09	.73		1.51	1.60	2.00	1.41
July	1.80	1.63	2.90	2.51	1.96	1.66		1.16	1.48	1.28	.93
August92	1.81	2.17	1.87	3.19	1.27		.96	.51	2.56	1.57
September...	2.08	2.37	1.21	4.29	3.51	2.74		2.18	1.83	3.06	2.69
October17	2.43	1.61	4.47	2.14	2.00		4.54	2.09	2.41	3.14
November...	2.43	2.27	1.46	3.91	1.75	1.30		2.32	3.09	2.13	2.83
December...	1.85	4.56	2.58	2.15	1.10	2.06		.53	2.61	2.62	1.88
TOTALS...	20.88	23.66	21.91	28.67	21.72	20.30		22.24	20.53	20.62	18.04 m.

1924. low. N.P. catechism 1926 g. on grass fairly level. sheer cliffs
1925 " " on east side about 200 ft. high + 40 ft. from gauge
houses on W 53ft. from g., other objects to N+S about 50 ft. away.
standards with run 1ft. above ground.

1927 - low m.p. average computed x/36 using records 1917-30
1928 - do - rejected as "low."
1930 low m.p. - ref. survey

Position of Station on reduced Ordnance Survey Map, 2 miles to 1 inch Series				No. of Map _____		Reference No. _____	
Date.	Lat. N.	Long.	Railway Station.	Distance from gauge	Direction	Parish Church.	Distance from gauge

RAINFALL at Pomona, Kirkwall

County of OrkneyObserver Rev. J. S. Bagg
dis/22

River Basin _____

Snowdon Rain Gauge, by Pastorelli & Raphin

Diameter ...	5"										
Height	10										
Altitude ...	75"										
Year	1920	1921	1922	1923	1924	1925	1926	1927	1928	1929	MEANS.
January ...	5.07	5.56						3.44			
February ...	4.67	1.78						2.13			
March	4.00	3.81						2.55			
April	1.84	2.04						5.65			
May	3.59	2.11						1.32			
June	5.1	2.49						3.38			
July	2.66	2.50						1.23			
August	1.23	3.00						0.74			
September...	3.15	4.00						2.95			
October	1.11	4.37						5.89			
November...	5.86							4.61			
December...	4.00							1.43			
TOTALS...	37.69	--						35.52			

1920 Gauge moved Jan 15th 50 yds S S E.

Position of Station on reduced Ordnance Survey Map, 2 miles to 1 inch Series				No. of Map		Reference No.	
Date.	Lat. N.	Long. W.	Railway Station.	Distance from gauge	Direction	Parish Church.	Distance from gauge
1911	56° 59'	2° 57'	Thurso	24 mi	S. S. W.	St. Magnus Cathedral	2007ds N. W.

RAINFALL at Pomona, Deerness

County of Orkney Observer W. Delday Esq. dec
River Basin _____ 1 log Moan
4.0 Rain Gauge, by _____

Diameter ...	5			5							
Height	4.0			4.0							1.0
Altitude ...	161			161							
Year	1920	1921	1922	1923	1924	1925	1926	1927	1928	1929	1930 MEANS.
January ...	4.72	5.50	2.96	5.11	3.04	2.96	3.20	3.98	5.18	1.35	3.08
February ...	4.38	2.15	1.99	3.65	3.39	3.80	2.00	2.19	3.40	1.07	0.85
March	4.16	3.25	2.25	5.2	1.56	3.04	5.35	2.24	2.35	.89	1.74
April	1.72	1.50	3.26	3.19	1.81	2.35	3.80	6.10	1.61	1.49	2.19
May	3.40	2.24	2.51	3.97	1.96	2.68	1.63	1.83	1.51	1.73	2.68
June	5.2	1.95	1.32	2.11	1.72	1.46	2.21	3.10	1.90	3.30	1.93
July	2.15	2.80	3.10	3.11	2.55	1.74	1.63	1.72	2.31	1.48	1.63
August	1.77	2.82	2.48	4.61	3.13	2.21	2.95	1.23	1.35	4.80	4.77
September...	3.41	3.79	2.76	5.41	5.03	3.49	4.76	3.34	2.22	5.94	4.43
October73	3.88	1.98	6.81	3.35	4.40	8.62	6.15	3.78	6.13	4.88
November...	5.74	2.90	2.90	6.16	2.62	2.25	3.87	4.50	4.28	4.45	4.26
December ...	3.29	7.57	4.96	4.35	2.26	2.74	5.46	1.34	4.05	5.71	3.72
TOTALS...	35.99	40.35	32.47	49.00	32.42	33.12	45.48	37.72	33.94	38.34	35.56

1930 Height of gauge reduced from 54" to 14" in June 1930.

Position of Station on reduced Ordnance Survey Map, 2 miles to 1 inch Series				No. of Map		Reference No.	
Date.	Lat. N.	Long.	Railway Station.	Distance	Direction	Parish Church.	Distance Direction from gauge
1914	58° 56'	2° 45'	Thurso	5.0 mi	S W	Deerness	1 mi N E

Bignold Park.

20

RAINFALL at Hickwall, Bank of Scotland.

County of Orkney

Observer James Davidson, Esq.

River Basin _____

MO Rain Gauge, by _____

Diameter ...								5			
Height								10			
Altitude ...								151		125	113' (Correct)
Year	1920	1921	1922	1923	1924	1925	1926	1927	1928	1929	1930 MEANS:
January ...								3.44	5.79	1.44	3.866
February ...								2.13	3.78	2.01	2.955
March								2.55	2.52	.96	2.214
April								5.65	1.48	1.91	2.737
May								1.52	1.31	1.66	2.737
June								3.38	1.90	2.88	2.494
July								1.23	2.35	1.15	1.675
August74	1.60	5.05	5.565
September...								2.95	2.77	5.57	5.050
October								5.89	4.00	7.16	5.767
November...								4.61	4.50	4.77	4.355
December...								1.43	4.12	6.69	3.494
TOTALS...								35.52	36.12	41.22	39.39

Screen 6½ Rgt 13' WNW
Wall 5' 26' E
House 25' 40 yds SW

1929. Aug. 27. R. moved 300 yds. N.
Screen 6½' high 18' S.E.
Wall 4½' " 14' N.E.
Hut. 9' " 33' S.S.W.

Position of Station on reduced Ordnance Survey } Map, 2 miles to 1 inch Series				No. of Map _____		Reference No. _____	
Date.	Lat. N.	Long.	Railway Station.	Distance from gauge	Direction	Parish Church.	Distance from gauge

RAINFALL at Hellyar Holm

County of Orkney

Observer Board of Northern Lights

River Basin _____

Rain Gauge, by _____

Diameter ...	3						5						
Height	1 0						1 3						
Altitude ...	60						35						
Year	1920	1921	1922	1923	1924	1925	1926	1927	1928	1929	1930. MEANS.	SUMS	
January ...	3.32	3.84	3.73	5.66	3.33	2.66	4.18	3.78	5.58	1.73	3.51	41.32	
February ...	3.49	1.53	2.42	3.85	2.90	3.94	2.65	2.16	3.70	1.51	1.17	29.32	
March	3.33	2.71	2.14	1.07	1.69	2.22	4.94	2.21	2.96	.77	1.78	25.82	
April61	1.39	3.12	2.98	2.03	2.20	2.86	5.39	1.87	2.05	1.91	26.41	
May	3.09	.81	3.27	4.03	1.94	3.10	1.44	1.27	1.50	1.56	2.60	24.61	
June	(.50)	1.70	1.56	1.67	1.68	1.06	1.55	3.46	1.70	2.96	1.29	19.13	
July	1.93	2.08	2.79	3.27	2.15	1.73	1.42	1.62	2.48	1.39	1.91	22.77	
August60	2.41	2.33	4.81	3.11	2.19	3.03	.96	1.61	4.69	5.66	31.40	
September...	2.42	2.42	2.72	4.72	4.83	3.96	4.48	3.07	2.36	4.99	5.04	41.01	
October65	4.01	1.88	5.94	3.44	3.31	8.11	5.73	4.01	6.65	4.98	48.71	
November...	4.18	2.97	3.22	6.81	3.14	2.38	4.65	4.55	4.71	4.38	4.45	45.44	
December...	3.64	6.91	4.51	4.14	2.94	2.89	4.67	1.18	4.16	5.35	3.37	43.76	
TOTALS...	(27.76)	32.78	33.69	48.95	33.18	31.64	43.98	35.38	36.64	38.03	37.67	399.70	

1920. June estimated from surrounding stations.
Catechism 1926 is on level ground, surrounded by a 4ft wall
dwelling houses 12 yds from S., garden 4 ft high about 23 ft.
from S. nearest well about 60 ft away. "Blind" gauge 5 in. in diam
ft 3 above ground

Position of Station on reduced Ordnance Survey Map, 2 miles to 1 inch Series				No. of Map		Reference No.	
Date.	Lat. N.	Long.	Railway Station.	Distance	Direction	Parish Church.	Distance
				from gauge			from gauge

RAINFALL at Auskerry

County of Orkney

Observer Board of Northern Lights

River Basin

Rain Gauge, by

Diameter ...	3						5				
Height	2.6						1.0				
Altitude ...	10						22				
Year	1920	1921	1922	1923	1924	1925	1926	1927	1928	1929	1930. MEANS.
January ...	2.94	3.08	1.37	4.47	3.29	2.88	3.04	3.09	3.41	1.45	3.46
February ...	2.31	.82	.81	3.05	2.82	4.12	2.03	2.17	1.24	.91	1.34
March	3.13	2.16	1.10	1.12	1.76	3.02	4.02	2.15	1.67	.45	1.79
April	1.33	.98	1.41	2.51	2.32	2.34	2.16	4.74	1.52	1.39	1.49
May	2.00	1.46	1.04	2.74	1.52	1.98	1.10	1.46	1.49	1.50	2.11
June36	1.17	.67	1.14	1.40	1.27	1.64	3.01	1.61	2.14	1.69
July	1.41	1.11	1.08	1.85	2.25	1.69	1.23	1.76	2.03	1.17	2.11
August49	1.20	1.05	2.99	2.83	1.80	2.76	.57	.85	4.37	4.22
September...	2.23	1.07	1.08	4.28	3.47	3.47	3.37	2.43	1.85	3.58	3.53
October46	1.21	.43	5.63	2.58	3.88	6.08	3.70	3.34	5.14	4.48
November...	3.42	.84	1.57	6.76	2.75	1.83	3.86	3.18	3.62	4.17	3.64
December...	1.77	3.28	2.97	3.46	3.26	2.45	4.28	1.13	4.10	5.76	2.94
TOTALS...	21.85	18.38	14.58	40.00	38.25	30.73	35.57	29.39	26.73	32.03	32.80.

Catechism 1926
Is. in centre of garden 6ft. from sundial + 5ft 3 in (SE)
Walls 6ft. high about 25 yds away on all sides. Ground nearly level.
Standards. run 1 ft. above ground.

Position of Station on reduced Ordnance Survey
Map, 2 miles to 1 inch Series

No. of Map

Reference No.

Date.	Lat. N.	Long.	Railway Station.	Distance from gauge	Direction	Parish Church.	Distance from gauge	Direction

RAINFALL at Shapinsay, Balfour Castle

County of Orkney

Observer Mr. W. Liddell

River Basin

Rain Gauge, by

Diameter ...	5"			5"		5"					
Height	0 6			0 6		5"	0 6				
Altitude ...	50			50		50'					
Year	1920	1921	1922	1923	1924	1925	1926	1927	1928	1929	1930 MEANS:
January ...	3.60	4.50	2.90	4.03	3.05	2.25	3.05	3.74	4.61	1.43	3 8.75 3691
February ...	3.80	1.50	2.10	3.75	2.55	3.35	2.20	2.05	3.40	.90	.85 2645
March	3.60	2.65	1.55	.75	1.30	1.75	3.50	1.60	1.63	.47	2.45 2125
April	2.00	1.30	2.70	2.40	1.75	2.50	2.20	5.10	1.30	1.67	1.45 2437
May	3.05	1.80	2.60	3.70	1.73	2.05	1.25	1.25	1.30	.95	2.07 2175
June28	1.55	1.50	1.20	1.33	.90	1.40	2.13	1.60	1.90	2.20 1599
July	2.45	1.70	2.75	2.05	2.20	1.50	1.10	1.35	2.35	1.03	1.80 2028
August55	2.15	2.80	4.30	3.10	1.70	2.05	.75	.87	4.03	6.03 2833
September...	2.60	2.50	2.70	3.76	4.20	4.02	3.70	2.45	1.90	5.65	4.20 3768
October80	3.20	1.60	5.50	3.30	3.16	7.53	5.03	3.50	6.85	4.55 4502
November...	5.00	2.75	2.90	6.35	2.40	2.18	3.60	3.55	3.50	3.95	3.85 4003
December...	3.60	6.00	4.03	3.41	2.20	2.65	3.60	.72	3.73	7.03	4.30 4127
TOTALS...	31.33	31.60	30.13	41.20	29.11	28.01	35.18	29.72	29.69	35.86	37.50 35933

1921. Balfour Castle 150 yds. N.W.

Hydro No. 765745

Position of Station on reduced Ordnance Survey
Map, 2 miles to 1 inch Series

No. of Map

Reference No.

Date.	Lat. N.	Long.	Railway Station.	Distance from gauge	Direction	Parish Church.	Distance from gauge	Direction

RAINFALL at Sandwich S.O. School

County of Orkney Observer J.A. Fotheringham Esq.

River Basin

M.O. Rain Gauge, by

Diameter	5"
Height	1' 4"
Altitude	51'
Year
	1920	1921	1922	1923	1924	1925	1926	1927	1928	1929	1930	
January	(4.60)
February	(1.20)
March	(2.60)
April	1.50
May	2.25
June	1.41
July	1.76
August	4.77
September	3.54
October	5.05
November	4.95
December	3.81
TOTALS	(37.34)

1930. Garden dyke 3' high 7 1/2' w
House 30' " 31 yds SSE.
Wireless pole. 40'-50' " 22 yds ESE.
1930. Jan. Feb. March 1-23rd estimated by neighbouring stations.

Position of Station on reduced Ordnance Survey Map, 2 miles to 1 inch Series				No. of Map.....		Reference No.....	
Date.	Lat. N.	Long.	Railway Station.	Distance from gauge	Direction	Parish Church.	Distance from gauge
1930.			Thurso	32 miles	S.W.	Sandwich	3 miles N.W.

RAINFALL at Sanday, Start Point

County of Corkney

Observer Board of Northern Lights

River Basin _____

Rain Gauge, by _____

Diameter ...	3						5				
Height	1	0									
Altitude ...	80						27				
Year	1920	1921	1922	1923	1924	1925	1926	1927	1928	1929	1930 MEANS.
January ...	3.88	5.56	4.00	4.57	3.64	2.39	2.33	4.14	6.30	2.29	4.64
February ...	3.74	1.51	2.31	3.71	2.76	3.91	1.82	2.04	4.47	1.83	1.19
March	3.94	4.44	2.64	.95	1.93	2.46	2.25	1.74	2.22	.60	2.46
April	1.80	1.43	2.58	2.38	2.47	2.11	2.06	5.90	1.35	1.59	2.29
May	2.32	2.04	2.30	3.09	1.22	1.94	2.01	1.70	1.19	1.12	1.82
June51	1.55	1.45	1.39	1.87	1.36	1.53	2.76	1.93	1.79	3.03
July	2.23	1.84	2.61	3.00	1.45	2.41	1.49	1.49	2.42	1.38	3.56
August	1.16	2.28	1.87	4.42	1.59	1.76	3.27	.30	1.84	4.29	4.80
September...	3.47	2.18	2.67	3.20	2.99	3.23	3.72	2.94	2.11	4.41	3.38
October50	3.28	1.38	4.02	2.82	3.90	6.45	5.42	3.77	6.44	4.68
November...	5.35	2.79	3.45	5.91	3.14	2.46	4.32	5.67	5.17	5.48	4.91
December ...	2.55	6.62	3.11	4.13	3.15	2.97	4.24	1.74	4.27	7.15	4.95
TOTALS...	31.45	35.52	30.37	40.77	29.03	30.90	35.49	35.84	37.04	38.37	41.71

Catchment 1926. 5. in garden surrounded by walls 4 ft. high
20-40 yds away on all sides
Standard 5. (blush) 5 in. in diam. 1 ft. above ground

Position of Station on reduced Ordnance Survey Map, 2 miles to 1 inch Series				No. of Map		Reference No.	
Date.	Lat. N.	Long.	Railway Station.	Distance	Direction	Parish Church.	Distance
				from gauge			from gauge

RAINFALL at *Westray, Roup Head*

County of *Corkney*

Observer *Board of Northern Lights*

River Basin.....

Rain Gauge, by.....

Diameter ...	3										
Height	1 0										
Altitude ...	260										
Year	1920	1921	1922	1923	1924	1925	1926	1927	1928	1929	1930. MEANS.
January ...	3.72	5.00	2.68	4.73	2.81	2.18		2.70	2.29	2.32	1.59
February ...	3.83	1.32	2.07	4.42	1.56	3.41		1.42	1.59	.79	1.09
March	3.11	3.16	1.77	4.46	2.02	1.41		1.83	1.49	.66	2.17
April	1.68	1.56	2.21	1.96	2.81	1.66		3.09	.84	1.44	1.48
May	2.15	2.54	2.31	2.97	1.14	1.58		1.10	1.33	.88	1.19
June78	1.99	1.34	1.02	1.92	.82		2.08	1.57	1.39	.94
July	3.27	1.96	2.19	2.97	2.09	1.49		.97	2.00	1.25	1.36
August	1.18	2.02	1.81	2.96	1.88	1.42		1.04	.52	2.99	4.63
September...	3.26	2.41	1.96	4.01	4.39	1.59		1.90	2.06	2.23	3.48
October70	3.23	1.74	4.04	2.54	3.42		2.94	2.01	2.59	3.40
November...	3.07	2.13	2.02	4.84	2.38	1.46		1.93	4.42	2.44	3.07
December...	2.91	5.47	3.61	2.86	3.65	1.60		1.58	2.32	2.79	1.76
TOTALS...	29.66	32.79	25.71	37.24	29.19	22.04		22.58	22.44	21.77	26.16

1925. N.P. low. Groundslopes down on S. One small rise of about 20ft. 100 yds beyond boundary wall to S. Boundary wall 8 yds E, 9 yds S, dwelling house 10 yds N. Standards with rim 1ft. above ground. With some wind spray in can for which a little is allowed. No. ediv. Oct '26. article ant. of rain to be sent in future as well as estimated proportion of spray.

1927 Low temp.
1928 do
1929 N. P. Low.
1930 N.P. Low.

Position of Station on reduced Ordnance Survey } No. of Map..... Reference No.....
Map, 2 miles to 1 inch Series

Date.	Lat. N.	Long.	Railway Station.	Distance Direction from gauge	Parish Church.	Distance Direction from gauge

RAINFALL at North Ronaldsay

County of Orkney

Observer Board of Northern Lights

River Basin

Rain Gauge, by

Diameter ...	3						5				
Height	0 4						0 9				
Altitude ...	140						22				
Year	1920	1921	1922	1923	1924	1925	1926	1927	1928	1929	1930. MEANS.
January ...	3.56	4.70	3.69	3.73	2.30	1.49	3.88	5.12	5.89	1.62	4.80
February ...	4.00	1.49	1.99	1.96	2.92	5.01	2.89	2.27	5.10	1.35	1.17
March	3.65	3.05	2.40	1.43	1.72	2.61	4.23	2.35	2.56	1.60	2.67
April	1.69	1.53	2.41	2.15	1.80	2.16	1.99	5.54	1.69	2.05	2.09
May	3.03	1.73	2.37	2.68	1.70	1.58	2.27	1.84	1.15	1.58	1.81
June	38	1.31	1.52	1.38	1.78	1.36	1.22	3.60	2.17	1.39	2.63
July	1.96	.88	2.55	2.59	1.01	2.50	1.13	2.07	2.26	2.56	2.60
August	90	1.54	1.93	4.04	1.55	1.60	4.96	.41	1.88	5.18	5.19
September...	2.58	1.44	2.66	2.18	1.23	3.32	4.11	3.31	1.79	5.41	3.32
October22	1.69	1.07	3.45	1.33	4.09	5.59	5.43	4.92	6.93	4.95
November...	4.73	2.37	3.13	5.61	1.24	2.61	5.13	4.18	5.57	4.79	5.08
December...	2.79	6.65	2.46	2.43	1.37	4.28	5.16	1.45	4.45	6.80	4.28
TOTALS...	29.49	28.38	28.18	32.63	16.95	32.61	42.56	37.57	39.43	40.26	40.09

1924. Red. N.P. Catechism 1926. S. in centre of garden, ground level, sundial 4 ft. high is 4 yds east of gauge. Standards. with rim 9 in. above ground.

Position of Station on reduced Ordnance Survey
Map, 2 miles to 1 inch Series

No. of Map

Reference No.

Date.	Lat. N.	Long.	Railway Station.	Distance from gauge	Direction	Parish Church.	Distance from gauge	Direction

RAINFALL at Sule Sherry

County of Cork

Observer Board of Northern Lights

River Basin _____

Rain Gauge, by _____

Diameter ...	3										
Height	0 6										
Altitude ...	113										
Year	1920	1921	1922	1923	1924	1925	1926	1927	1928	1929	1930. MEANS.
January ...	4.43	5.65	3.69	5.35	3.87	3.01		1.73	3.63	1.48	1.86
February ...	5.08	1.57	2.38	1.79	3.53	2.45		.94	2.33	.88	.43
March	2.19	3.78	2.36	.61	3.66	2.51		.45	1.15	.31	1.70
April	1.91	1.00	1.01	2.34	2.98	.80		2.05	1.41	.90	1.11
May	2.29	2.50	2.66	2.74	.45	1.77		.99	.80	1.05	.78
June78	.84	2.17	1.83	2.45	1.21		.52	.59	.60	.63
July	2.19	1.93	1.87	4.21	2.33	2.04		.60	1.36	.91	.61
August83	2.38	2.32	4.32	4.87	1.62		.99	1.41	2.72	3.15
September...	3.38	4.85	2.22	4.27	3.61	1.77		.87	1.05	2.17	3.42
October89	4.61	2.12	4.76	2.44	2.53		3.17	2.15	3.83	4.04
November...	4.87	1.67	2.32	5.53	3.11	.78		2.54	2.96	2.92	2.94
December...	2.81	5.94	3.95	4.38	4.51	3.53		.59	1.81	2.64	2.73
TOTALS...	31.65	36.72	29.07	42.13	37.81	24.02		15.44	20.65	20.41	23.40

1925, N.P. Catechism 1926. S. on rough ground not enclosed in any way, & fairly level. Tower 45 yds S.W. of S. is only building within 100 yds. Standard gauge 5 in. in diam. + rim 1 ft 1 in above ground. Whole island gets a heavy fall of sea spray & in a dry gale S. always contains salt water.

1927 Low. N.P.
1928 do.
1929 do.
1930 Low. N.P.

average computed x/36 using records 1876-1930
rejected as 4" low ref. survey.

Position of Station on reduced Ordnance Survey
Map, 2 miles to 1 inch Series

No. of Map _____

Reference No. _____

Date.	Lat. N.	Long.	Railway Station.	Distance from gauge	Direction	Parish Church.	Distance from gauge	Direction

RAINFALL at Lerwick (Fort Charlotte)

County of Shetland Observer Meteorological Office

River Basin _____

Met Office Rain Gauge, by _____

Diameter ...	8										
Height	1 0										
Altitude ...	59	54 154	154	154 54	54						
Year	1920	1921	1922	1923	1924	1925	1926	1927	1928	1929	1930. MEANS.
January ...	5.42	6.22	3.78	5.88	4.14	5.34	5.22	6.94	7.65	2.67	5.80
February ...	5.82	4.03	3.22	4.51	3.99	6.29	4.62	3.22	5.36	1.96	1.57
March	6.01	5.06	2.37	.94	3.22	2.69	6.09	4.07	2.38	1.20	2.91
April	1.98	2.61	2.19	1.76	5.41	2.89	1.68	6.03	1.58	1.48	2.17
May	2.96	2.54	3.55	4.09	3.34	2.22	2.19	1.84	1.22	1.88	1.52
June75	.92	1.51	2.22	2.23	1.00	1.41	2.85	3.69	2.17	2.98
July	3.45	2.09	4.01	1.87	4.00	1.66	1.12	1.96	2.03	1.13	2.51
August	1.25	1.91	4.42	4.18	1.75	2.39	3.74	1.25	3.02	4.57	4.36
September...	2.34	3.53	4.15	5.34	4.07	3.74	4.85	3.60	2.52	4.26	3.27
October42	4.58	1.83	4.74	3.05	4.72	2.68	3.56	5.48	8.70	4.74
November...	5.64	2.84	4.80	7.43	2.70	2.42	4.81	6.05	5.32	7.89	4.82
December...	3.81	5.59	3.84	5.22	7.75	40.0	4.61	1.59	5.86	8.13	5.48
TOTALS...	39.85	41.92	39.67	47.68	45.65	39.36	43.02	42.96	46.41	45.98	42.13
	D	D	D	D	D	D	D	D	D	D	D

14.4.21 Station transferred to The Nab - $\frac{3}{4}$ mile from Fort Charlotte.
(See met. mag. 1921. vol. 56. p. 162)
2.4.23 Transferred back to old site at Fort Charlotte

Position of Station on reduced Ordnance Survey Map, 2 miles to 1 inch Series				No. of Map		Reference No.	
Date.	Lat. N.	Long. W.	Railway Station.	Distance from gauge	Direction	Parish Church.	Distance from gauge
1920	60° 9'	1° 8'				Established 1912	1/2 mi SSE

RAINFALL at Bressay

County of Shetland

Observer Board of Northern Lights

River Basin

Rain Gauge, by

2 2

Diameter ...	3										
Height	1 0										
Altitude ...	105										
Year	1920	1921	1922	1923	1924	1925	1926	1927	1928	1929	1930-MEANS.
January ...	2.42	11.2 2.53	2.40	1.16	1.12			2.89	2.10	2.06	2.14
February ...	3.87	10.9 2.76	2.82	1.72	1.28			1.12	1.09	1.25	.95
March	4.81	12.3 3.62	1.28	.65	1.39			1.07	.67	.49	2.34
April	1.38	5.5 1.38	3.34	1.01	1.93			2.11	.46	.94	1.67
May	2.19	8.5 2.14	1.80	2.17	1.89			.41	.82	.79	1.01
June53	4.8 1.22	.99	.67	1.68			1.21	2.31	1.31	2.08
July	1.80	6.0 1.51	2.50	1.14	3.75			.69	.99	.60	2.59
August87	5.3 1.34	4.04	1.33	.80			.42	2.60	3.07	4.12
September...	1.67	9.7 2.45	1.61	2.34	1.55			1.45	1.69	2.12	2.57
October82	6.7 1.70	.97	1.50	2.69			1.82	3.75	3.70	3.43
November...	4.79	6.5 1.64	1.78	4.30	2.19			1.46	3.03	2.06	2.63
December...	3.00	10.5 2.65	1.18	1.26	3.24			.91	2.34	3.36	4.52
TOTALS...	28.15	25.24	24.71	19.25	23.53			15.56	21.85	21.75	30.05.

1923, low. N.P.

1924 low. n.p

Catechism 1926 is on level ground surrounded by tower, dwelling houses, barnhouse + wall. Tower 50⁺ft high 12yds away
houses 17. . . 10
barnhouse 7. . . 7
wall 4 1/2 . . . 25
Beyond wall ground slopes down steeply on 2 sides. Standards, with rumb. in above ground.

1927) Low up
1928) Low up
1929 do

1930. Low up. Enc 17 of 76517/30.

Position of Station on reduced Ordnance Survey Map, 2 miles to 1 inch Series

No. of Map

Reference No.

Date.	Lat. N.	Long.	Railway Station.	Distance Direction from gauge	Parish Church.	Distance Direction from gauge

RAINFALL at Lerwick Observatory

County of Shetland Observer Air Ministry

River Basin

Rain Gauge, by

Lerwick Obsy will continue to use period of 24 hours gh-gl for British Rainfall see Min. 23 f 834612/28

+A

1916
-19
16
846
1457
1064
680
794
540
779
1924
2586
2013
1695
16070

Diameter ...				8								
Height				1.0								
Altitude ...				269								
Year	1920	1921	1922	1923	1924	1925	1926	1927	1928	1929	1930 MEANS.	
January ...	(565)	(569)	(392)	5.48	3.69	4.44	4.53	5.60	6.00	2.56	5.50	5306
February ...	(606)	(355)	(334)	4.58	3.27	5.21	3.90	2.76	4.13	.82	1.45	3907
March	(626)	(559)	(246)	1.02	2.47	2.27	4.85	4.11	2.68	.91	2.68	3530
April	(206)	(205)	(227)	2.22	3.98	2.76	1.73	5.87	1.89	1.27	1.97	2807
May	(308)	(303)	(368)	3.89	3.36	2.38	2.76	1.77	1.55	1.71	1.48	2869
June	(78)	(135)	(156)	2.06	2.32	1.29	1.42	3.13	3.38	2.47	2.66	2242
July	(359)	(213)	(416)	1.87	3.79	1.66	1.26	2.03	2.13	1.17	2.93	2672
August	(130)	(165)	4.58	4.09	2.06	2.28	4.32	1.18	3.47	4.42	4.17	3352
September...	(244)	(290)	(430)	4.64	4.39	3.76	4.56	3.94	2.57	4.05	2.96	4051
October	(144)	(525)	(190)	4.51	3.24	4.42	3.57	3.99	5.57	7.77	4.99	4565
November...	(588)	(338)	(498)	6.64	2.68	2.03	4.59	5.60	5.30	6.11	4.45	5164
December ...	(397)	(570)	(398)	4.38	6.63	3.02	4.34	1.27	5.23	6.94	4.82	5028
TOTALS...	(4151)	(4227)	4113	45.38 D	41.88 D	35.52 D	41.83 D	41.25 D	43.90 D	40.20 D	40.06 D	45493

Values have been computed for Lerwick Observatory for each month and year 1901-1922 inclusive, and are contained in Branch Folder No. M.O.3/20. (Climate Broadcast Averages)

Position of Station on reduced Ordnance Survey Map, 2 miles to 1 inch Series				No. of Map		Reference No.		
Date.	Lat. N.	Long.	Railway Station.	Distance from gauge	Direction	Parish Church.	Distance from gauge	Direction
1923	60° 9' 10"	11'	Aberdeen					

RAINFALL at Eshaness

County of Shetland Observer Comm^{rs} of N^w Lights

River Basin.....

Rain Gauge, by.....

Diameter											
Height											
Altitude											
Year	1920	1921	1922	1923	1924	1925	1926	1927	1928	1929	1930
January										(2.25)	4.33
February										(1.25)	1.17
March87	2.87
April										2.49	1.62
May										1.76	1.45
June										1.46	2.94
July										1.19	1.91
August										3.52	4.82
September										3.58	2.19
October										9.04	4.93
November										5.20	4.29
December										5.26	2.41
TOTALS										(37.87)	34.93

1929. Jan. & Feb. est^d from sur^g stations.
former station stopped Feb. 1919. Resumed Mar. 1929.

Position of Station on reduced Ordnance Survey Map, 2 miles to 1 inch Series				No. of Map.....		Reference No.....	
Date.	Lat. N.	Long. W	Railway Station.	Distance from gauge	Direction	Parish Church.	Distance from gauge
1929 (approx)	60° 28'	1° 38'					

RAINFALL at Feltan, The Manse

County of Shetland

Observer Rev. J. A. Campbell dead 1922

River Basin

Rain Gauge, by H. & J.

Diameter ...	5"										
Height	1 0										
Altitude ...	30										
Year	1920	1921	1922	1923	1924	1925	1926	1927	1928	1929	MEANS.
January ...	4.81	4.08	2.32								
February ...	3.36	2.11	2.65								
March	4.02	5.57	2.10								
April	2.16	2.50	4.41								
May	3.41	2.33	2.99								
June	61	78	1.36								
July	2.84	1.01	3.11								
August	87	1.49	3.13								
September...	1.86	1.70	2.54								
October	57	3.86	1.60								
November...	4.69	2.57	3.32								
December...	2.69	4.16	3.03								
TOTALS...	31.89	32.16	32.56	N.R.	N.R.				N.R.		

1920. Manse 30ft high 42ft N.
Hall 6 " " 18 " E.
Tree 10 " " 16 " S.E.

90 91 92 % of av 35.5 "

Hyd. Sta. No. 93-760153
NGR: HU (411) 609907
alt. 9m

Position of Station on reduced Ordnance Survey Map, 2 miles to 1 inch Series			No. of Map		Reference No.		
Date.	Lat. N.	Long. W.	Railway Station.	Distance Direction from gauge	Parish Church.	Distance Direction from gauge	
1920	60° 35' 40"	0° 3' 33"			Feltan	2307ds S.W.	

Observer Board of Northern Lights

Rain Gauge, by

1927 } How up
1928 }
1929 do.
1930 do.

Reference No.

[illegible]

RAINFALL at Fair Isle, South

County of Shetland Observer Board of Northern Lights

River Basin _____

Rain Gauge, by _____

Diameter ...											
Height											
Altitude ...											
Year	1920	1921	1922	1923	1924	1925	1926	1927	1928	1929	1930. MEANS.
January ...	1.10	1.70	1.10	1.91	.46			1.35	2.39	1.44	2.46
February ...	1.82	.62	1.48	1.78	1.33			2.23	2.16	.42	.64
March	2.24	1.49	.66	.88	.72			1.48	1.15	.72	.53
April97	.84	1.05	.38	.79			5.18	.61	.96	1.62
May	1.76	1.17	1.48	2.09	.40			1.14	.35	.97	.69
June14	.69	.70	.62	.57			2.37	.78	1.33	1.64
July	1.06	.72	1.92	1.14	.83			.81	.85	.81	1.30
August42	.99	1.70	1.35	.86			.26	1.63	3.72	2.70
September...	2.06	.86	2.52	2.23	1.51			1.37	1.30	1.81	1.81
October08	1.06	.81	1.30	.56			3.09	2.67	3.83	3.56
November...	2.00	1.06	1.61	2.30	.56			1.19	3.66	3.78	2.14
December...	1.29	2.49	1.32	1.43	1.14			.59	3.71	4.11	2.85
TOTALS...	14.94	13.69	16.35	17.41	9.73			21.06	21.26	23.90	21.94

~~1923 low up~~
~~1924 low up~~
1920 - Bad, not published
1921 - "
1922 - "
1923 - "
1924 - "

Catechism 1926. 5. on top of boundary wall, 5 ft. above ground inside + 8 ft. above on outside. "Blancher" gauge 5 in. in diam.
October 1926. Instructions give to run 1" above ground.

1927 - Low up
1928 - do
1929 - do
1930 Low up.

Position of Station on reduced Ordnance Survey } No. of Map _____ Reference No. _____
Map, 2 miles to 1 inch Series

Date.	Lat. N.	Long.	Railway Station.	Distance from gauge	Direction	Parish Church.	Distance from gauge	Direction

RAINFALL at Sumburgh Head

County of Shetland

Observer Board of Northern Lights

River Basin _____

Rain Gauge, by _____

Diameter ...				5							
Height				1 3 1/2							
Altitude ...				260							
Year	1920	1921	1922	1923	1924	1925	1926	1927	1928	1929	1930. MEANS.
January ...	2.97	1.92	1.66	2.26	2.20	2.47		3.43	4.01	.87	1.45
February ...	2.42	1.38	1.85	2.72	1.90	3.76		1.72	2.10	.39	.41
March	2.69	1.93	1.12	.46	1.38	1.45		1.23	1.36	.61	.70
April98	1.21	1.26	.79	2.22	.82		2.71	.74	.35	2.18
May	1.73	1.72	1.16	1.69	1.53	1.69		1.21	.73	.92	.69
June49	.66	.66	.95	.69	.56		1.67	1.48	.98	2.13
July	1.96	.95	2.70	.72	1.75	.84		.97	.83	.43	.55
August63	1.07	2.52	2.25	1.37	.84		.58	1.76	1.48	1.89
September...	1.95	1.45	3.15	3.77	1.93	3.15		2.82	1.57	1.10	.48
October25	1.60	1.08	2.34	2.01	1.92		2.58	2.80	1.54	1.67
November...	2.63	1.00	2.49	5.23	1.12	1.21		2.63	2.68	1.57	2.02
December...	1.38	2.55	1.35	2.47	4.50	1.76		.47	2.19	2.67	2.99
TOTALS...	20.08	17.44	21.00	25.65	22.60	20.47		22.02	22.25	12.91	7.16

1924. Low. N. P. Catechism 1926. S. on promontory, cliffs to SE + N.W.
1925 " 32 yds apart + 260ft. high. S. in enclosure - 3ft. wall
about 10 yds to SE + NW. Standard S. 1ft. 4 in. above
ground.

1927 } Low up
1928 }
1929 do "
1930 do "

Position of Station on reduced Ordnance Survey Map, 2 miles to 1 inch Series				No. of Map _____		Reference No. _____	
Date.	Lat. N.	Long.	Railway Station.	Distance from gauge	Direction	Parish Church.	Distance from gauge

RAINFALL at Baxter, Vementy

County of Shetland Observer Andrew Jait

River Basin _____

Snowdon Rain Gauge, by _____

Diameter ...					5						
Height					1						
Altitude ...					25						
Year	1920	1921	1922	1923	1924	1925	1926	1927	1928	1929	1930 MEANS.
January ...						4.29	4.90	5.86	6.34	2.23	5.06
February ...						5.84	3.62	2.82	5.53	1.27	.83
March						2.32	4.86	3.64	2.18	.80	2.54
April.....						2.06	1.39	4.31	1.46	1.51	1.64
May						1.45	2.63	1.38	1.17	1.97	1.68
June						1.53	1.51	3.63	4.78	1.47	2.69
July						1.39	.96	2.04	2.30	1.32	1.12
August						1.84	3.34	1.45	2.95	3.74	4.67
September...						3.72	5.40	3.76	2.53	3.86	2.61
October.....					# imp	3.93	4.00	2.51	5.86	8.22	5.07
November...					2.86	2.70	5.35	5.35	5.32	6.35	4.52
December...					7.65	3.25	4.59	.67	5.44	7.49	6.01
TOTALS...					imp	34.32	42.55	37.42	45.86	40.23	38.44
						D	D	D	D	D	D

1929. Stone wall 4' high, 60' S.
Fence 3' 6" " 20' E.
House 25' " 100' S.

Position of Station on reduced Ordnance Survey } Map, 2 miles to 1 inch Series				No. of Map.....		Reference No.....		
Date.	Lat. N.	Long.	Railway Station.	Distance from gauge	Direction	Parish Church.	Distance from gauge	Direction
1928.						Twatt.	4m.	S.

RAINFALL at Unst, Balti Sound, Halligarth

County of Shetland

Observer D^r J. E. Saxby

River Basin _____

Shousdon Rain Gauge, by H. J.

Diameter ...	5			5								
Height	1 0			1 0								
Altitude ...	31			31					20.			
Year	1920	1921	1922	1923	1924	1925	1926	1927	1928	1929	1930 MEANS.	
January ...	6.57	6.29	2.71	6.59	4.00	5.47	4.64	6.57	6.81	3.07	4.16	5688
February ...	6.10	3.92	3.62	4.11	3.85	6.79	4.78	3.76	4.30	1.52	1.20	4395
March	6.51	6.18	3.49	1.23	3.17	3.08	4.81	3.85	2.21	1.04	3.67	3924
April	3.72	2.27	4.38	3.61	2.62	1.88	2.65	5.54	1.95	3.15	1.65	3342
May	3.86	3.35	3.61	4.55	3.16	1.77	2.84	2.02	1.54	2.14	1.49	3033
June	81	1.49	2.10	2.64	2.25	1.18	1.71	4.46	6.32	2.75	3.97	2968
July	3.04	2.35	3.37	2.27	4.87	1.93	1.03	0.94	2.97	1.02	1.93	2572
August	98	1.82	4.03	3.80	1.72	2.38	4.55	2.25	3.72	3.83	2.93	3201
September...	3.22	3.20	3.90	6.00	3.51	3.68	4.92	4.40	2.82	3.27	4.48	4340
October	73	5.80	2.09	4.89	3.17	4.91	4.11	4.03	5.33	7.37	5.51	4794
November...	6.44	3.74	6.09	9.11	3.91	5.09	5.33	5.14	5.41	6.39	5.47	6212
December...	4.04	6.30	5.90	5.92	7.71	3.74	5.42	1.32	5.98	6.30	4.96	5759
TOTALS...	46.02	46.71	45.29	54.72	43.94	41.90	46.79	44.28	49.36	41.85	41.42	50228

Position of Station on reduced Ordnance Survey
Map, 2 miles to 1 inch Series

No. of Map _____

Reference No. _____

Date.	Lat. N.	Long.	Railway Station.	Distance from gauge	Direction	Parish Church.	Distance from gauge	Direction
1912	60°45'40"	0°51'				Parish	1 mi	W

